

NOTES FOR POND AND INFILTRATION AREA:

1. THE INFILTRATION AREA SHALL BE CONSTRUCTED FROM OUTSIDE THE BASIN LIMITS. IF THIS IS NOT POSSIBLE FOR SOME AREAS, ONLY LOW GROUND PRESSURE EQUIPMENT SHALL BE ALLOWED TO COMPLETE THE WORK. RUBBER Tired EQUIPMENT IS STRICTLY PROHIBITED FROM WORKING WITHIN THE INFILTRATION AREAS.
2. IN ORDER TO MAXIMIZE THE INFILTRATION RATE OF THE SOILS, THE CONTRACTOR SHALL MAKE EVERY EFFORT POSSIBLE TO AVOID COMPACTION OF THE POND AND INFILTRATION AREA, ABOVE THE NWL OF 956.8.
3. EXCAVATION SHALL BE COMPLETED WITH A BACKHOE TO MINIMIZE COMPACTION OF THE SOILS.
4. ANY COMPACTION OF INFILTRATION AREA SOILS MUST BE LOOSENEED BY THE CONTRACTOR.
5. THE FINISHED GRADE ELEVATIONS ON THE PLANS INDICATE THE FINISHED GRADE OF THE TOPSOIL OR PLANTING SOIL.
6. GRADING TOLERANCE FOR SUB CUT:  
VERTICAL +/- 0.1 FEET  
HORIZONTAL +/- 1.0 FEET
7. THE CONTRACTOR SHALL SURVEY THE BOTTOM ELEVATION OF THE RETENTION POND AND INFILTRATION AREA UPON COMPLETION OF THE SUB CUT AND PROVIDE THE SURVEY INFORMATION TO THE ENGINEER. THE ENGINEER SHALL NOTIFY THE CONTRACTOR OF AREAS THAT DO NOT MEET THE TOLERANCES SPECIFIED.
8. GRADING TOLERANCES FOR THE FINISHED GRADE OF THE BASINS:  
VERTICAL +/- 0.2 FEET  
HORIZONTAL +/- 0.5 FEET
9. THE CONTRACTOR SHALL CONTACT THE ENGINEER UPON FINAL PLACEMENT OF THE PLANTING SOIL/TOPSOIL SO THAT A SURVEY OF THE FINISHED GRADE CAN BE COMPLETED. THE ENGINEER SHALL NOTIFY THE CONTRACTOR OF AREAS THAT DO NOT MEET THE TOLERANCES SPECIFIED. THE CONTRACTOR SHALL CORRECT THE WORK ACCORDINGLY.
10. THE INFILTRATION AREA SHALL INCLUDE 2" DEEP LAYER OF ORGANIC COMPOST (MNDOT SPEC 3890 FOR GRADE 2 COMPOST) TO BE TILLED INTO THE TOP 6" LAYER OF THE EXISTING SANDY SOILS.
11. SILT FENCE SHALL BE PLACED AROUND THE INFILTRATION AREA TO PREVENT SEDIMENT FROM ACCUMULATING IN THE BASIN DURING CONSTRUCTION.

GENERAL NOTES:

1. FOR EXISTING STORM CATCH BASINS REQUIRING ADJUSTED RIM ELEVATIONS, SALVAGE AND REUSE CASTINGS IF EXISTING CASTINGS ARE NEENAH R-3067 TYPE R GRATE. IF CASTINGS ARE NOT THE ABOVE TYPE, FURNISH NEENAH R-3067 TYPE R CASTINGS TO REPLACE EXISTING.

LEGEND

- DENOTES IRON MONUMENT FOUND
- DENOTES IRON MONUMENT SET
- DENOTES LIGHT POLE
- DENOTES GUY WIRE
- DENOTES POWER POLE
- DENOTES CATCH BASIN
- DENOTES WATER VALVE
- DENOTES FIRE HYD
- DENOTES STORM MANHOLE
- DENOTES SANITARY MANHOLE
- DENOTES SANITARY SEWER LINE
- DENOTES WATER MAIN LINE
- DENOTES STORM SEWER LINE
- DENOTES FENCE
- DENOTES EXISTING TREE
- DENOTES EXISTING TREE

- 990— DENOTES MAJOR CONTOUR (AS-BUILTS)
- 966— DENOTES MINOR CONTOUR (AS-BUILTS)
- 966— DENOTES PROPOSED CONTOUR

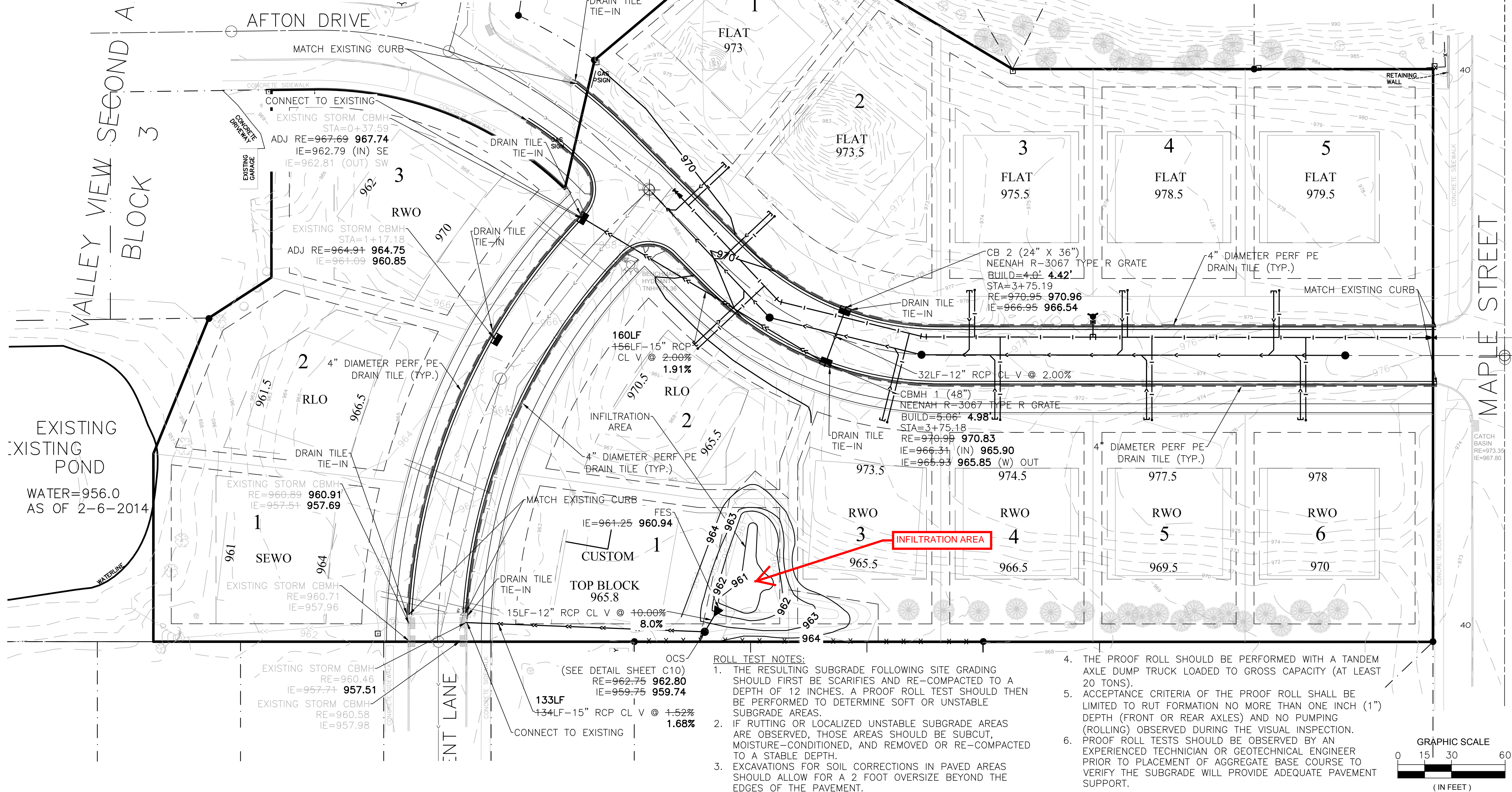

ROLL TEST NOTES:

1. THE RESULTING SUBGRADE FOLLOWING SITE GRADING SHOULD FIRST BE SCARIFIED AND RE-COMPACTED TO A DEPTH OF 12 INCHES. A PROOF ROLL TEST SHOULD THEN BE PERFORMED TO DETERMINE SOFT OR UNSTABLE SUBGRADE AREAS.
2. IF RUTTING OR LOCALIZED UNSTABLE SUBGRADE AREAS ARE OBSERVED, THOSE AREAS SHOULD BE SUBCUT, MOISTURE-CONDITIONED, AND REMOVED OR RE-COMPACTED TO A STABLE DEPTH.
3. EXCAVATIONS FOR SOIL CORRECTIONS IN PAVED AREAS SHOULD ALLOW FOR A 2 FOOT OVERSIZE BEYOND THE EDGES OF THE PAVEMENT.
4. THE PROOF ROLL SHOULD BE PERFORMED WITH A TANDEM AXLE DUMP TRUCK LOADED TO GROSS CAPACITY (AT LEAST 20 TONS).
5. ACCEPTANCE CRITERIA OF THE PROOF ROLL SHALL BE LIMITED TO RUT FORMATION NO MORE THAN ONE INCH (1") DEPTH (FRONT OR REAR AXLES) AND NO PUMPING (ROLLING) OBSERVED DURING THE VISUAL INSPECTION.
6. PROOF ROLL TESTS SHOULD BE OBSERVED BY AN EXPERIENCED TECHNICIAN OR GEOTECHNICAL ENGINEER PRIOR TO PLACEMENT OF AGGREGATE BASE COURSE TO VERIFY THE SUBGRADE WILL PROVIDE ADEQUATE PAVEMENT SUPPORT.

RECORD DRAWINGS

REVISIONS BY

REVISED	GRADING	DATE
08/14/14		
01/28/15		
02/13/15		
04/20/17		

I HEREBY CERTIFY THAT THIS PLAN OR SPECIFICATION WAS PREPARED BY ME OR UNDER MY DIRECT SUPERVISION AND THAT I AM A FULLY REGISTERED CIVIL ENGINEER UNDER THE LAWS OF THE STATE OF MINNESOTA.

Russell A. Tweden  
DATE: 03/13/2015 REG. NO. 26821

318 CEDAR STREET  
SAINT PAUL, MN 55101  
(651)294-0038  
SOLUTIONBLUE.COM

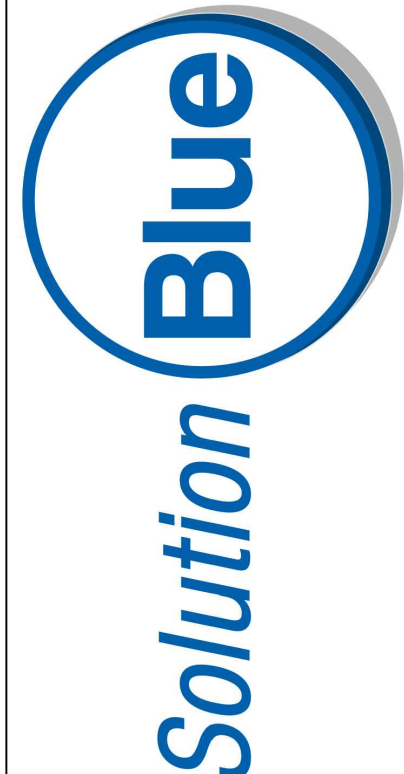

GRADING AND  
DRAINAGE PLAN  
VALLEY VIEW 4TH ADDITION  
TOM GILL CONSTRUCTION  
CITY OF NORTHFIELD

DRAWN BY	RAT/LMM
CHECKED BY	RAT
DATE	05/08/14
JOB NO.	108#140301
SHEET	

C4