

MINNESOTA DEPARTMENT OF TRANSPORTATION

COUNTY OF RICE

CSAH I RECONSTRUCTION

CONSTRUCTION PLAN FOR:

ROADWAY RECONSTRUCTION, ROUNDABOUT CONSTRUCTION, TRAIL CONSTRUCTION, BRIDGE NO. 66J79, CURB AND GUTTER, GRADING, BASE, BITUMINOUS SURFACING, STRIPING & SIGNAGE, WATERMAIN, FORCEMAIN, AND STORM SEWER

STATE AID PROJ. NO. 066-601-020

GROSS LENGTH 8531.30 FEET = 1.615 MILES
 BRIDGE LENGTH 16.45 FEET = 0.003 MILES
 EXCEPTIONS-LENGTH 0.00 FEET = 0.000 MILES
 NET LENGTH 8514.85 FEET = 1.612 MILES

GEOGRAPHIC LOCATION: CSAH 1 (110TH ST E) FROM INTERSECTION WITH TH 3(2ND AVE NW), 8572 FT. EAST TO INTERSECTION OF TH 246(DENNISON BLVD)

LEGAL DESCRIPTION: RICE COUNTY SECTIONS 11, 12, 13 AND 14 TOWNSHIP 111, RANGE 20

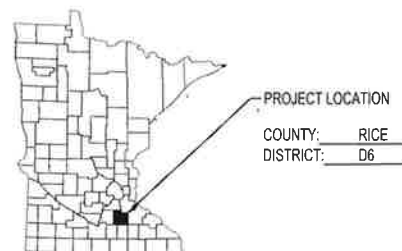
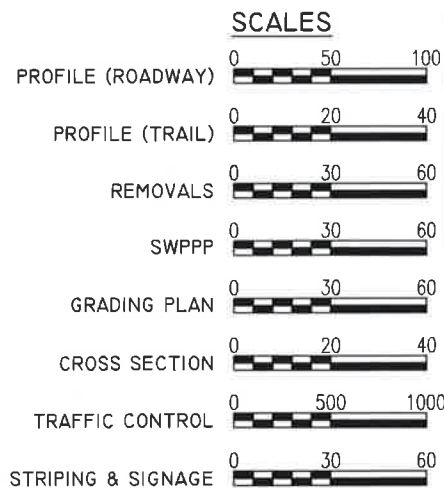
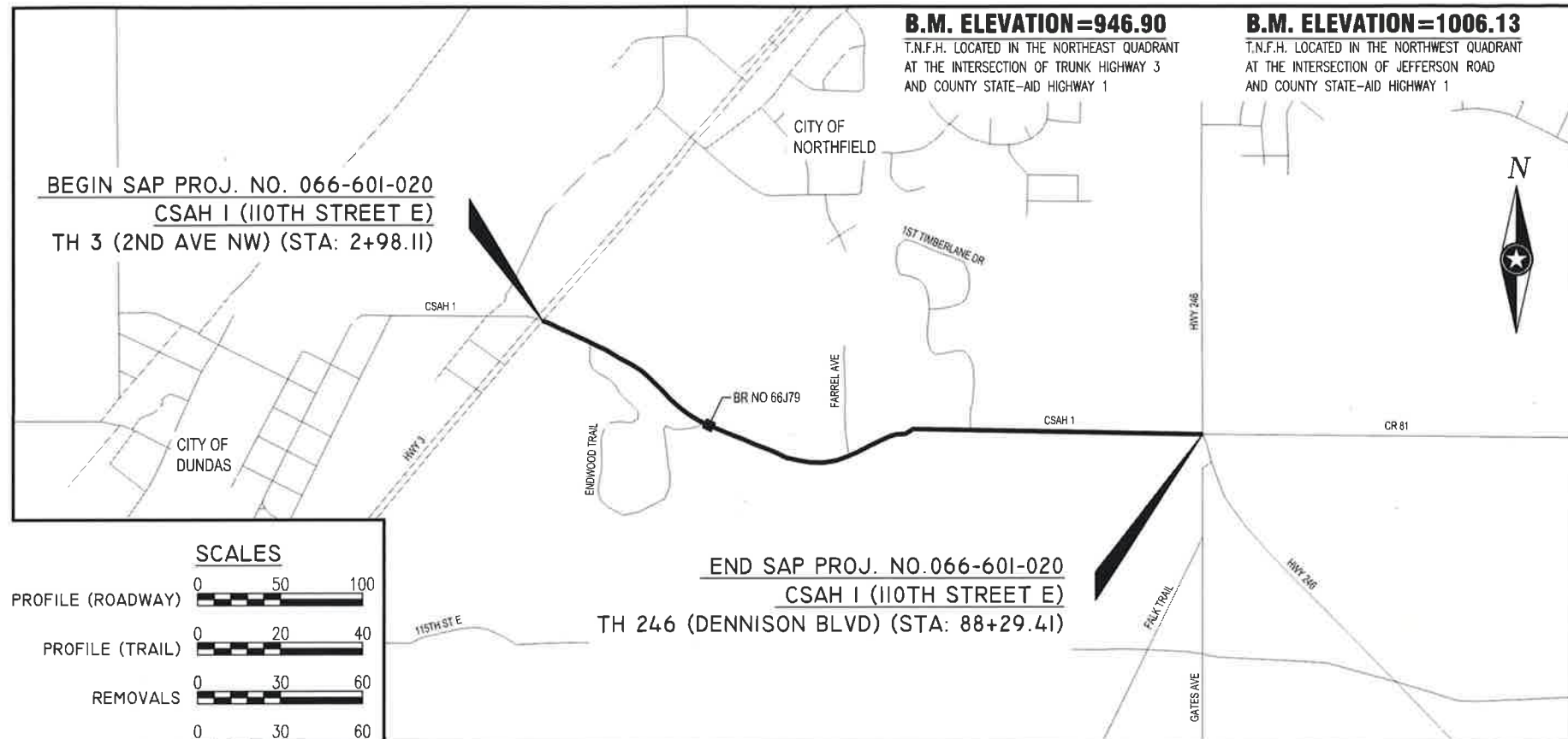

GENERAL SITE NOTES:

- THE UTILITY INFORMATION IN THIS PLAN IS UTILITY QUALITY LEVEL C. THIS QUALITY LEVEL WAS DETERMINED ACCORDING TO THE GUIDELINES OF CI/ASCE 38-2, ENTITLED "STANDARD GUIDELINES FOR THE COLLECTION AND DEPICTION OF EXISTING SUBSURFACE UTILITY DATA"
- THE LOCATION AND TYPE OF ALL INPLACE UTILITIES SHOWN ON THE PLANS ARE FOR GENERAL INFORMATION ONLY AND ARE ACCURATE AND COMPLETE TO THE BEST OF THE KNOWLEDGE OF I&S GROUP, INC. NO WARRANTY OR GUARANTEE IS IMPLIED. THE CONTRACTOR SHALL VERIFY THE SIZES, LOCATIONS AND ELEVATIONS OF ALL INPLACE UTILITIES PRIOR TO CONSTRUCTION. CONTRACTOR SHALL IMMEDIATELY NOTIFY ENGINEER OF ANY DISCREPANCIES OR VARIATIONS FROM PLAN.
- THE CONTRACTOR IS TO CONTACT "GOPHER STATE ONE CALL" FOR UTILITY LOCATIONS, 48 HOURS PRIOR TO EXCAVATION/CONSTRUCTION. (1-800-252-1166) A "GOPHER STATE ONE CALL" MAY OR MAY NOT HAVE BEEN PERFORMED AT THE TIME OF THE TOPOGRAPHIC SURVEY.

DESIGN DESIGNATION

R VALUE	12	DESIGN ESALS	2,098,000
ROAD DESIGN		10 TON	
SOIL FACTOR		100	
ROADWAY CLASSIFICATION	CSAH 1 (HWY 3 TO STA. 54+00) MINOR ARTERIAL	CSAH 1 (STA. 54+00 TO HWY 246) MINOR ARTERIAL	
DESIGN SPEED	40'	55	
AADT (2018)	5,750	5,750	
AADT (2038)	10,010	10,010	
SHOULDER WIDTH	8'	8'	
NO. OF TRAFFIC LANES	2	2	
NO. OF PARKING LANES	0	0	
STOPPING SIGHT DISTANCE BASED ON:			
HEIGHT OF EYE	3.5'	HEIGHT OF OBJECT	2'

*DESIGN SPEED NOT ACHIEVED AT ROUNDABOUT APPROACHES

REVISIONS



Eng. Proj. No. 15-18528

S.A.P. No. 066-601-020 (CSAH 1)

GOVERNING SPECIFICATIONS

THE 2018 EDITION OF THE MINNESOTA DEPARTMENT OF TRANSPORTATION "STANDARD SPECIFICATIONS FOR CONSTRUCTION" SHALL GOVERN, INCLUDING APPLICABLE TECHNICAL MEMORANDUMS.

ALL TRAFFIC CONTROL DEVICES SHALL CONFORM TO THE MUTCD, INCLUDING THE LATEST EDITION OF THE FIELD MANUAL FOR TEMPORARY TRAFFIC CONTROL ZONE LAYOUT.

SHEET INDEX

- 1 TITLE SHEET
- 2 GENERAL LAYOUT
- 3-5 STATEMENT OF ESTIMATED QUANTITIES & STANDARD PLATES
- 6 EARTHWORK SUMMARY
- 7 CONSTRUCTION NOTES
- 8 REMOVAL SCHEDULES
- 9-10 UTILITY SCHEDULES
- 11 EXISTING TYPICAL STREET SECTION
- 12 TYPICAL STREET SECTION
- 13-30 DETAILS
- 31 BRIDGE NO 66J79 SURVEY
- 32-34 FINAL PLAT
- 35-41 REMOVALS PLAN
- 42-44 STORMWATER POLLUTION PREVENTION PLAN NOTES
- 45-49 STORMWATER POLLUTION PREVENTION PLAN DETAILS
- 50-65 SWPPP & GRADING PLAN
- 66 OVERALL UTILITY PLAN
- 67 HYDRANT COVERAGE PLAN
- 68-74 PLANNED ROAD & STORM SEWER PLAN
- 75-80 STORM SEWER CROSS-SECTIONS
- 81-82 ROUNDABOUT
- 83-87 PLANNED TRAIL & STORM SEWER CONSTRUCTION
- 88 PLANNED DRIVEWAY CONSTRUCTION
- 89-92 PLANNED UTILITY RELOCATION
- 93-94 SUPERELEVATION PLAN
- 95 ROUNDABOUT CONSTRUCTION PLAN
- 96 CONCRETE PAVING PLAN
- 97-127 CROSS-SECTIONS - CSAH 1
- 128-129 CROSS-SECTIONS - HIGHLAND PKWY
- 130 DETOUR PLAN
- 131 TEMPORARY ACCESS ROAD
- 132 TEMPORARY TRAFFIC CONTROL DETAILS
- 133-143 SIGNAGE & STRIPING PLAN
- 144-147 SIGNAGE DETAILS
- 148-149 PHOTOMETRIC PLAN
- 150-152 LIGHTING PLAN
- 153 LIGHTING DETAILS

I HEREBY CERTIFY THAT THIS PLAN WAS PREPARED BY ME OR UNDER MY DIRECT SUPERVISION AND THAT I AM A DULY LICENSED PROFESSIONAL ENGINEER UNDER THE LAWS OF THE STATE OF MINNESOTA.

DESIGNER ENGINEER: *Mathew Thibert* TYPED OR PRINTED NAME: MATHEW THIBERT

DATE: 11/30/17 LIC. NO. 51719

APPROVED: RICE COUNTY ENGINEER: *John Kolan* DATE: 11/30/17

STATE AID APPROVALS:

DISTRICT STATE-AID ENGINEER: _____ DATE: _____
 REVIEWED FOR COMPLIANCE WITH STATE AID RULES/POLICY

STATE-AID ENGINEER: _____ DATE: _____
 APPROVED FOR STATE AID FUNDING

TITLE SHEET

SHEET 1 OF 153 SHEETS