



106GROUP

Main Office

550 Vandalia St
Suite 102
St Paul MN 55114

Locations

Boston MA
Richmond VA
Washington DC

106group.com

July 30, 2024

Kelly Gragg-Johnson
Environmental Review Specialist
State Historic Preservation Office
50 Sherburne Avenue
Administration Building 203
Minneapolis, MN 55155

Re: Design Review for Bridge Square-Riverside Park Improvement Project –
Phase I
Northfield, Dakota and Rice Counties
SHPO Number: 2022-1266

The City of Northfield has contracted with landscape architects Damon Farber to develop designs for Phase I of the Bridge Square-Riverside Park Improvement Project (Project). The Project involves the rehabilitation of Bridge Square, which is a contributing property to the National Register of Historic Places (NRHP)-listed Northfield Commercial Historic District (District).¹ In order to comply with the Minnesota Historic Sites Act and Minnesota Field Archaeology Act, the current project design needs to meet the *Secretary of the Interior's Standards for the Treatment of Historic Properties (SOI Standards)* to avoid adversely affecting the District. Rehabilitation is defined as “the act or process of making possible a compatible use for a property through repair, alterations, and additions while preserving those portions or features which convey its historical, cultural or architectural values.”² The following document is limited to an architectural history design review and does not include results or recommendations regarding the Phase I archaeological survey discussed below.

The District is listed in the NRHP for its significance under Criterion A, in the areas of Settlement, Industry, and Commerce, and under Criterion C, in the area of Architecture. The period of significance for the District is 1856-1966. Bridge Square (RC-NFC-400) is a contributing property within the District and is immediately adjacent to other contributing buildings and structures within the District. Bridge Square includes four individual resources: Bridge Square (a

¹ Carole Zellie, *Northfield Commercial Historic District (NRIS 79003125) Boundary Decrease and Additional Documentation*, prepared by Landscape Research, LLC, October 2020, Certified March 2021.

² National Park Service, *The Secretary of the Interior's Standards for the Treatment of Historic Properties* (Washington, D.C.: U.S. Department of the Interior, 2017), 2.

contributing site); Riverside Park (a contributing site); the Civil War Monument (a contributing structure); and the stone sculpture (a non-contributing structure).³

Although not explicitly defined in existing inventory forms or reports, character-defining features of Bridge Square may be understood to include the contributing sites and structure identified above. Additionally, the Minnesota State Historic Preservation Office (SHPO) has identified the extant Water Street corridor between Bridge Square and Riverside Park to be a character-defining feature.⁴ Water Street historically defined the spatial relationships of the two sites and surrounding properties in the twentieth century and helped shape the “asymmetrical triangular perimeter” of Bridge Square found in 1916 concept plans developed by Minneapolis landscape architect Phelps Wyman (Figure 1).⁵ The two large concrete planters, existing treescapes and vegetation, and topography and viewsheds are also important features to consider.

In December 2023, the City of Northfield submitted 60% designs to SHPO for review, which featured substantial changes to the design, in response to comments received from SHPO, the Northfield Heritage Preservation Commission, and Northfield community members. The SHPO letter from January 2024, written in response to the 60% designs, states that:

“Based on our review of the submitted documentation, we are pleased to see that the design has been refined in response to comments received from our office, the Northfield Heritage Preservation Commission, and Northfield community members. In our opinion, the current design is much more compatible with the forms of both Riverside Park and Bridge Square, and we have determined that the project, as currently proposed in the 60% construction documents, has been designed in accordance with the SOI Standards. We look forward to reviewing the 90% construction documents when they become available.”⁶

³ National Park Service, *The Secretary of the Interior's Standards for the Treatment of Historic Properties* (Washington, D.C.: U.S. Department of the Interior, 2017), 2.

⁴ Kelly Gragg-Johnson, Environmental Review Program Specialist, SHPO to David Bennett, Public Works Director/City Engineer, City of Northfield, May 6, 2022.

⁵ Carole Zellie, *Northfield Commercial Historic District (NRIS 79003125) Boundary Decrease and Additional Documentation*, prepared by Landscape Research, LLC, October 2020, Certified March 2021; “Plan for the Improvement of Mill Square,” *Northfield News*, April 7, 1916, 1.

⁶ Kelly Gragg-Johnson, Environmental Review Program Specialist, SHPO to David Bennett, Public Works Director/City Engineer, City of Northfield, January 4, 2024.

Given the January 2024 response from SHPO, Damon Farber has made no significant updates to the 60% designs. As with the 60% plans, the 90% design plans include the minimization of paving, landscape features, and proposed materials throughout the park. These design elements will help maintain the informal openness of the park and the extant slope of the landscape toward the river.

However, the 90% design plans do include minor changes made to the 60% designs and proposed public art elements, which were approved by the Northfield Arts and Culture Commission on July 8, 2024.⁷ On July 9, the Northfield City Council voted unanimously to support the pursuit of a National Endowment for the Arts (NEA) Grants for Arts Projects (GAP), which would fund the public art design, fabrication, and installation.⁸

As a result, updated design components presented in 90% design plans include:⁹

Overall Minor Changes

- The addition of two sets of two concrete stairs and handrails at the pedestrian walkway running from 4th Street to the northwest edge of the Bridge Square Plaza to Riverside Park and the Gathering Lawn. The addition of these low-profile stairs at this location ensures that the design maintains the desired, extant slope toward the river. Wheelchair access from 4th Street to Riverside Park and from Riverside Park to Bridge Square Plaza is maintained at other prominent locations.
- Reconfiguring the parking area at the northeast side of 4th Street, to create a total of four parking spaces along 4th Street. Permeable pavers will be installed at this parking area. As part of the ongoing public engagement efforts, local downtown businesses requested more parking; this adjustment addresses that request.

⁷ Natalie Draper, Director of Library Services, Northfield Public Library, to Lindsey Wallace, Senior Architectural Historian and Planner, 106 Group, July 10, 2024.

⁸ City of Northfield City Council Resolution 2024-073, July 9, 2024.

⁹ Damon Farber, Northfield Bridge Square Site Plan; Northfield Bridge Square Site Hardscape Plan; Northfield Bridge Square Tree Planting Plan; Northfield Bridge Square Understory Planting Plan, June 28, 2024; Damon Farber, Public Art Views, June 28, 2024; Discussion with the City of Northfield, Damon Farber, 106 Group, and artist John Sterner, June 28, 2024; Natalie Draper, Director of Library Services, Northfield Public Library, to Rachel Baudler Blaseg, PLA, Damon Farber, and Lindsey Wallace, Senior Architectural Historian and Planner, 106 Group, June 18, 2024.

- The consolidation of two parking spaces near the southwest corner of Division Street and Bridge Square Street. Permeable pavers will be installed at this parking area.
- The addition of low, truncated, domed, curbs at a few locations to provide a physical, textural transition at the ground level between the park's edge and the vehicular traffic lanes. These low, domed curbs are proposed to be installed at these locations to increase accessibility, particularly for those with low or no vision. Locations of these low, transitional curbs include several small areas along Bridge Square Street and along the southeast edge of the permeable paver parking section near the southwest corner of Division Street and Bridge Square Street.
- The addition of several precast, curved seat walls adjacent to Bridge Square Plaza, located to the west of the fountain.
- Slightly widening the pedestrian walkway at the edge of Cannon River to provide less congested, easier riverfront access for pedestrians and those using wheelchairs and strollers.
- Slightly changing the shape of two planting beds at the southwest edge of Bridge Square Plaza from two parallelograms to a different parallelogram shape and a rectangle to address issues of constructability at this specific location.
- The addition of three flat, paved steppers in the rain garden, which is located adjacent to the southeast edge of Bridge Square Street, near the southwest perimeter of the park. These steppers will provide pedestrian access through the rain garden to protect the plantings.

Public Art

The Northfield Arts and Culture Commission formally voted to approve the following proposed public art elements¹⁰ on July 8, 2024.¹¹ A representative from the Northfield Heritage Preservation Commission sits on the public art review committee, which is an ad hoc subcommittee of the commission. On July 9, the Northfield City Council voted unanimously to support the pursuit of a National

¹⁰ Damon Farber, Northfield Bridge Square Site Plan; Northfield Bridge Square Site Hardscape Plan, June 28, 2024; Damon Farber, Public Art Views, June 28, 2024; Discussion with the City of Northfield, Damon Farber, 106 Group, and artist John Sterner, June 28, 2024; Natalie Draper, Director of Library Services, Northfield Public Library, to Rachel Baudler Blaseg, PLA, Damon Farber, and Lindsey Wallace, Senior Architectural Historian and Planner, 106 Group, June 18, 2024.

¹¹ Natalie Draper, Director of Library Services, Northfield Public Library, to Lindsey Wallace, Senior Architectural Historian and Planner, 106 Group, July 10, 2024.

Endowment for the Arts (NEA) Grants for Arts Projects (GAP), which would fund the public art design, fabrication, and installation.¹²

- Installation of seven, 7-8-foot steel sculptures along Water Street: five sculptures at the west side of the street and two on the east side. These sculptures will be downlit in accordance with the City of Northfield's Land Development Code Outdoor Lighting Standards, which follow Minnesota Statute 16B.328, the state law regulating light pollution.
- Installation of flat, lightly etched granite pavers along the entire east perimeter of the Gathering Lawn.

Architectural History Design Review

A summary of the architectural history design review for Bridge Square, a contributing property to the NRHP-listed District, is provided below. This work was completed by an architectural historian who meets the *Secretary of the Interior Professional Qualifications Standards*.

The *SOI Standards for Rehabilitation* state that “The historic character of a property will be retained and preserved. The removal of distinctive materials or alteration of features, spaces and spatial relationships that characterize a property should be avoided.”¹³

Character-defining features of Bridge Square include the spatial relationship between the contributing sites of Bridge Square and Riverside Park, particularly as defined by the Water Street Corridor; the presence of the contributing Civil War Monument near the center of Bridge Square; the topography of a relatively flat space that slopes toward the Cannon River; circulation systems; and the presence of vegetation, including lawn, landscaped beds, and trees.

The Water Street corridor has been retained in the current 90% designs, as has the spatial relationship between Bridge Square and Riverside Park. The current design retains the evolved teardrop shape of Bridge Square that began in 1916 and underwent alterations circa 1975. In the current design, the softened contours of Riverside Park also echo historic boundaries of that portion of the park. The Civil War Monument will be retained and preserved in place. The extant circulation system, vegetation, and park furnishings largely postdate the

¹² City of Northfield City Council Resolution 2024-073, July 9, 2024.

¹³ National Park Service, 2017:76.

District's period of significance. However, the circulation system in the proposed design closely echoes the extant, circa 1975 circulation system and the mix of lawn, planting beds with low masses of plants. Both retained and newly planted trees proposed in the design will echo the historic mix of vegetation present throughout the evolution of Bridge Square.

The minor changes between the 60% and 90% plans, delineated above, will not require the removal of distinctive materials or alteration of features, spaces, and spatial relationships that characterize this property. Further, these minor changes have been included in the 90% design plans to support additional accessibility and pedestrian access, maintain the existing landscape slope toward the Cannon River, and address requests from local business owners.

The addition of two sets of two concrete stairs and handrails at the pedestrian walkway running from 4th Street to the northwest edge of the Bridge Square Plaza to Riverside Park and the Gathering Lawn ensures that the design maintains the desired, extant slope toward the river. Wheelchair access from 4th Street to Riverside Park and from Riverside Park to Bridge Square Plaza is maintained at other prominent locations.

The proposed public art includes the installation of seven, 7-8-foot steel sculptures along Water Street: five sculptures at the west side of the street and two on the east side, and the installation of flat, lightly etched granite pavers along the entire east perimeter of the Gathering Lawn. While the proposed sculptures are relatively tall, they are not nearly as tall as the existing trees located within the same area of the park in which they are proposed to be installed. Further, though these sculptures are proposed to be located on Water Street, they will not adversely affect the existing landscape slope of the park or the existing, historic viewshed of the Cannon River from Bridge Square. The sculptures will be lit in similar fashion to the lighting plan for the entire park, all of which is in accordance with the City of Northfield's Land Development Code Outdoor Lighting Standards, which follow Minnesota Statute 16B.328, the state law regulating light pollution. As they are flat and slated for installation at a location that had already been planned to have pavers installed, the lightly etched granite pavers will not disrupt the landscape slope or viewshed, nor remove or alter existing materials.

The sculptures may require the installation of footings four feet in depth, which is the maximum depth of the archaeological field survey shovel tests performed at

Bridge Square for this project. Please see the Archaeology Survey section for details on public art installation and potential archaeological resources below.

As the current 90% design retains and preserves the character-defining features of the landscape, it meets the *SOI Standards for Rehabilitation*. As described in further detail below, the Archaeological Monitoring and Discovery Plan will outline strategies for archaeological monitoring during construction, as well as mitigation measures for any unanticipated, potential effects to historic resources that could come from the construction of the current design or installation of public art.

The *SOI Standards for Rehabilitation* state that “New additions, exterior alterations, or related new construction will not destroy historic materials, features, and spatial relationships that characterize the property. The new work will be differentiated from the old and will be compatible with historic materials, features, size, scale and proportion, and massing to protect the integrity of the property and its environment.”¹⁴

As discussed above, the current 90% design retains historic materials, features, and spatial relationships that are character-defining features of Bridge Square. Likewise, the historic integrity of these features will not be diminished by new construction, including the minor changes between the 60% and 90% designs, delineated above. The current 90% design includes minimal grading of some areas of the park, including the permanent tiered seating area of Riverside Park, which is intended to retain the overall grade of the park and keep open areas of the park relatively flat. This area of the park has been graded several times during and after the District’s period of significance.

As with the 60% designs, the 90% plan will retain the characteristic slope of the site and existing viewshed from the District to the river. Proposed paving material for the Water Street corridor and the public art pavers proposed to be installed at the perimeter of the Gathering Lawn will be stone or concrete pavers, in a color similar to the extant concrete. These pavers, as well as the proposed permeable pavers at the two additional parking locations and the pavers used throughout the park, will echo surfacing materials used historically at the site but will be clearly differentiated from historic surfaces. Similarly, planting beds will be constructed of concrete and gray or sandstone in color, thus complimenting surrounding materials in the District but differentiated as modern materials.

¹⁴ Ibid., 76.

Further, the slight change in shape of the planting beds at the southwest edge of Bridge Square Plaza will not destroy existing materials, features, or spatial relationships. Additionally, the planting beds are designed, so that, per *SOI Standards*, if removed in the future “the essential form and integrity of the history property and its environment would be unimpaired.”¹⁵

Newly installed landscaping, including low-massing plants and trees, will supplement existing vegetation and will not alter the property or surrounding viewsheds. Similarly, the addition of two sets of two concrete stairs and handrails at the pedestrian walkway running from 4th Street to the northwest edge of the Bridge Square Plaza to Riverside Park and the Gathering Lawn will not alter the property significantly and will help ensure the existing historic landscape slope can be maintained.

The extant railings along the Cannon River are relatively new and are not character-defining features of Bridge Square. The slight widening of the pedestrian walkway along the Cannon River will not alter the existing viewshed or landscape slope, and it will provide easier access for pedestrians and those operating wheelchairs or strollers. Taken together, new grading and materials proposed in the current 90% designs will be differentiated from historic surfaces and materials and will not alter the degrade the integrity of setting of Bridge Square or the surrounding District.

The proposed public art will not destroy historic spatial relationships, and it will be compatible with historic materials, features, size, scale and proportion, and massing of the existing park. The sculptures may require the installation of footings four feet in depth, which is the maximum depth of the archaeological field survey shovel tests performed at Bridge Square for this project. Please see the Archaeology Survey section for details on public art installation and potential archaeological resources below.

Therefore, the new elements proposed in the current 90% design meet the *SOI Standards for Rehabilitation*. As described in further detail below, the Archaeological Monitoring and Discovery Plan will outline strategies for archaeological monitoring during construction, as well as mitigation measures for any unanticipated, potential effects to historic resources that could come from the construction of the current design or installation of public art.

¹⁵ *Ibid.*, 76.

Archaeological Survey

While this architectural history design review document does not fully address potential subsurface archeological resources, per SHPO guidance, a Phase I archeological survey of the project area was undertaken by 106 Group.¹⁶ That survey identified one post-contact archaeological site (21RA0076) that contained both intact and disturbed material evidence of the 1856 surface of Mill Square and disturbed architectural remnants near the historical location of John North's 1856 Grist Mill. As part of the survey report, titled *Phase I Archaeological Investigation for the Bridge Square-Riverside Park Renovation Project*, 106 Group archaeologists recommended construction monitoring and the potential rerouting of utility lines.¹⁷ The intent of these recommendations is to allow archaeological resources to "be protected and preserved in place" or, if resources must be disturbed, allow for appropriate documentation and mitigation measures in order to meet the *SOI Standards for Rehabilitation*.¹⁸

In the response letter to this survey report, dated April 17, 2024, SHPO stated:

"Based on our review of the report, Phase I Archaeological Investigation for the Bridge Square – Riverside Park Renovation Project, Northfield, Rice County, Minnesota (106 Group, October 2023), we conclude that archaeological site 21RC0076 is contributing to the National Register-listed Northfield Commercial Historic District (RC-NFC-00263) under Criterion A as representing archaeological features associated with the early period of significance of the district and under Criterion D for the site's potential to provide more information about the industrial development, community planning, and of the people who used these spaces during the district's period of significance. The site may also be individually eligible; however, this has not been fully evaluated."

SHPO concurred with the need for an Archaeological Monitoring and Discovery Plan and recommended the City include potential mitigation measures. SHPO and 106 Group met on June 11, 2024, to discuss the appropriate next course of action, which is outlined in detail below.

¹⁶ Johnson to Bennett, May 6, 2022.

¹⁷ Kate Hunt and Tyler Lund-Kyrola, *Phase I Archaeological Investigation for the Bridge Square-Riverside Park Renovation Project*, Prepared by 106 Group for the City of Northfield, October 2023.

¹⁸ National Park Service, 2017:76.

The proposed public art sculptures may require the installation of footings four feet in depth, which is the maximum depth of the archaeological field survey shovel tests performed at Bridge Square for this project. 106 Group notes that due to the findings of the Phase I Archaeology Survey, the current planned location of the footings may affect archaeological resources. While the proposed sculpture locations to the north are outside of the boundaries for the archaeological site 21RC0076, the proposed sculpture locations at the south are within the site boundaries of 21RC0076 and could *potentially* disturb the historical surface of Bridge Square if the footing is reaching a depth of four feet below the surface. These locations, however, would likely *not* disturb the resources associated with the Grist Mill.

In order to address the potential disturbances to the archaeological site 21RC0076, and in accordance with the discussions held with SHPO held on June 11, 2024, and via email on July 17, 2024¹⁹, 106 Group will draft an, Archaeological Monitoring and Unanticipated Discoveries Plan that will include potential mitigation measures for any unanticipated discovery that occurs during construction of the current park designs and/or the installation of the proposed public art. Per SHPO's review letter, for the purposes of the Archaeological Monitoring and Unanticipated Discoveries Plan, archaeological site 21RC0076 will be considered both a contributing resource to the Northfield Commercial Historic District and a potential individually NRHP-significant resource.

Continuing the ongoing consultation process with SHPO and the Northfield Heritage Preservation Commission, as well as following the *SOI Standards for Rehabilitation* and the *Guidelines for the Treatment of Cultural Landscapes*, will ensure that proposed work meets applicable requirements and avoids and/or mitigates any adverse effects to Bridge Square or the District.

Consulting Party and Public Engagement

Throughout this project, the City has been consulting with various constituent groups, including the Northfield Heritage Preservation Commission, the Arts and Culture Commission, the Planning Commission the Parks and Recreation Advisory Board, City Staff, the Mayor, the City Council, the Chamber of Commerce, Carleton College, St. Olaf College, Northfield Schools, local business owners, the Lions Club, Rotary Club, and Garden Club, special project groups, and individual citizens. Since January 2024, the City has consulted

¹⁹ Kelly Gragg-Johnson, Environmental Review Program Specialist, SHPO, to Lindsey Wallace, Senior Architectural Historian and Planner, 106 Group, July 17, 2024.

specifically with the Northfield Heritage Preservation Commission on several occasions, including a special working session on April 3, 2024, in which the City and Lindsey Wallace, Senior Architectural Historian and Planner at 106 Group, discussed the Secretary of the Interior's Standards and the design review responsibilities and purview of the Northfield Heritage Preservation Commission. As they have with the 30% and 60% design plans, the City will present and discuss the 90% design plans with the Northfield Heritage Preservation Commission to gather feedback.

Regarding public art, the City has continuously engaged the Arts and Culture Commission. The Arts and Culture Commission is collaborating with local indigenous artists Marlena Myles (Dakota, Minneapolis) and John Sterner (Lakota, Marshall) to create the public artwork in Bridge Square that centers the stories, traditions, and perspectives of Native Americans, in line with the City of Northfield's land acknowledgment statement. The Arts and Culture Commission formally voted to approve the proposed public art in Bridge Square, and the City Council issued a resolution to support the pursuit of a National Endowment for the Arts (NEA) Grants for Arts Projects (GAP), which would fund the public art design, fabrication, and installation.

Sincerely,

THE 106 GROUP LTD.

A handwritten signature in blue ink, appearing to read 'LW', with a long horizontal flourish extending to the right.

Lindsey Wallace
Sr. Architectural Historian and Planner
Planning Team Manager

site plan



90% SHPO

NORTHFIELD
BRIDGE
SQUARE
NORTHFIELD, MN

I hereby certify that this document was prepared by me or under my direct supervision and that I am a duly licensed Landscape Architect under the laws of the State of Minnesota.

Name Tom Whitlock
Registration# 26292

Signature _____ Date _____
06/28/2024

DF/ Project # 22-184

Scale AS SHOWN

Drawn/Checked RP/AG/BE/RB

REVISION _____

NOT FOR
CONSTRUCTION

SITE
HARDSCAPE
PLAN

L101

SITE HARDSCAPE LEGEND

SYMBOL	DESCRIPTION
•	BOLLARD DESCRIPTION [BO-01] BOLLARD TYPE 01 - REMOVABLE SPEC: 32 33 00
	EDGING DESCRIPTION [ED-01] EDGING TYPE 01 - CIP FLUSH CONCRETE CURB SPEC: 32 13 16
	HANDRAIL DESCRIPTION [HR-01] GUARDRAIL TYPE 01 SPEC: 05 50 01 [HR-02] HANDRAIL TYPE 01 SPEC: 05 50 01
	MISCELLANEOUS DESCRIPTION [M-01] PUBLIC ART SCULPTURE
	PAVING DESCRIPTION [P-01A] PAVING TYPE 01A - DECORATIVE CONCRETE PEDESTRIAN LIGHT ETCH SPEC: 32 13 13 [P-01B] PAVING TYPE 01B - DECORATIVE CONCRETE VEHICULAR LIGHT ETCH SPEC: 32 13 13 [P-02A] PAVING TYPE 02A - DECORATIVE CONCRETE PEDESTRIAN MEDIUM ETCH SPEC: 32 13 16 [P-02B] PAVING TYPE 02B - DECORATIVE CONCRETE VEHICULAR MEDIUM ETCH SPEC: 32 13 16 [P-03A] PAVING TYPE 03A - UNIT PAVING SPEC: 32 14 00 [P-03B] PAVING TYPE 03B - UNIT PAVING SPEC: 32 14 00 [P-03C] PAVING TYPE 03C - UNIT PAVING PERMEABLE [P-04A] PAVING TYPE 04A - STANDARD CONCRETE PEDESTRIAN [P-04B] PAVING TYPE 04B - STANDARD CONCRETE VEHICULAR
	ROCK DESCRIPTION [RO-01] ROCK TYPE 01 - STORMWATER BOULDER CROSSING
	STAIRS DESCRIPTION [ST-01] STAIR TYPE 01 - CIP CONCRETE STAIR SPEC: 32 13 13 [ST-02] STAIR TYPE 02 - PRECAST CONCRETE STEP SPEC: 03 45 00
	WALL DESCRIPTION [WL-01] WALL TYPE 01 - 10" PRECAST WALL SPEC: 03 45 00 [WL-02] WALL TYPE 02 - 8" CIP WALL SPEC: 32 13 13 [WL-03] WALL TYPE 03 - PRECAST CURVED SEAT WALL - LAWN SPEC: 03 45 00 [WL-04] WALL TYPE 04 - PRECAST CURVED SEAT WALL - PROMENADE SPEC: 03 45 00 [WL-05] WALL TYPE 05- PRECAST CURVED WALL - PLAZA SPEC: 03 45 00

NOTES:

- REFER TO L001 FOR GENERAL NOTES AND ABBREVIATIONS.
- REFER TO L002 FOR LANDSCAPE NOTES.
- REFER TO L003 FOR TREE PRESERVATION PLAN, NOTES & DETAILS.

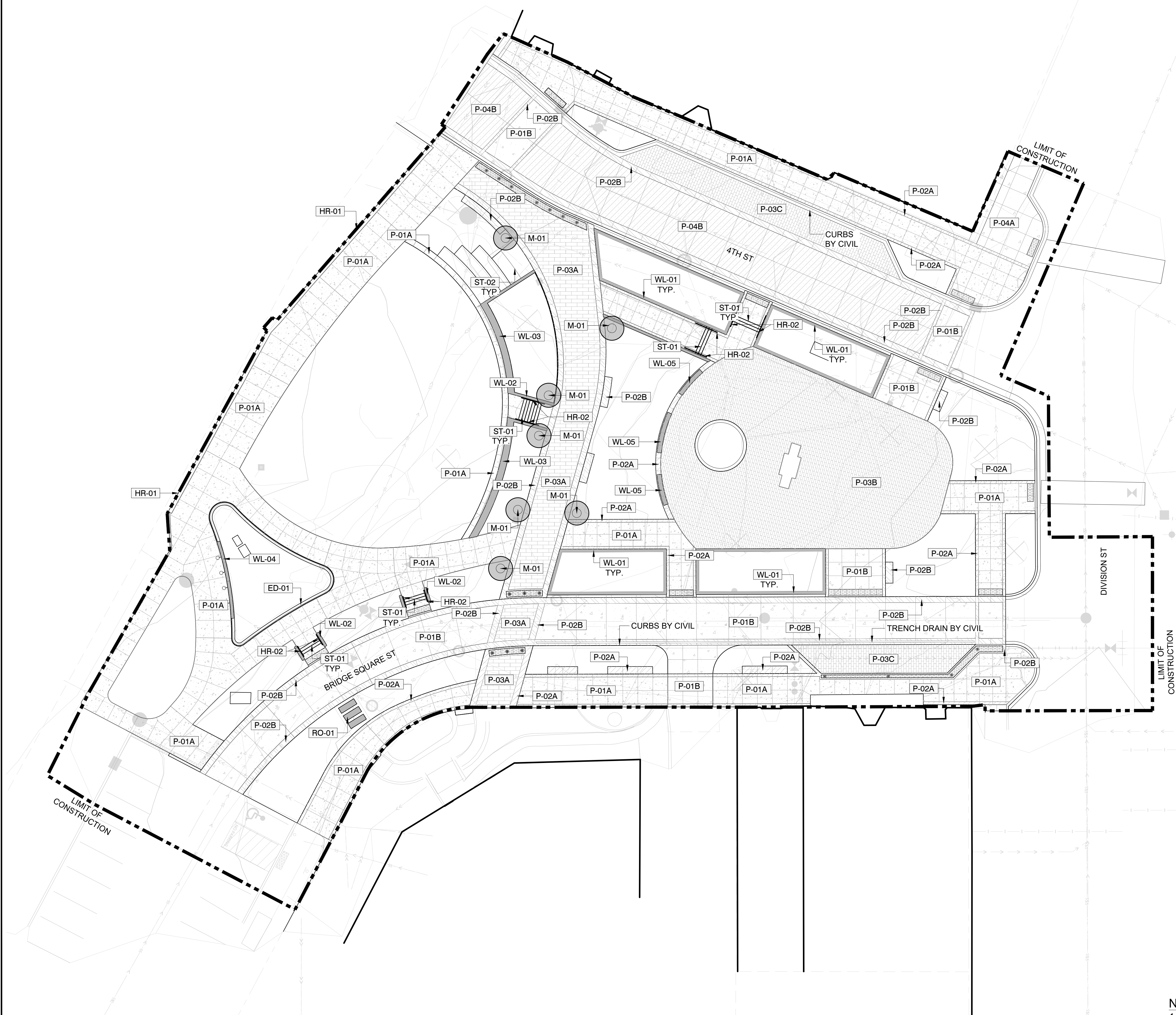

01 SITE HARDSCAPE PLAN
1" = 16'-0"

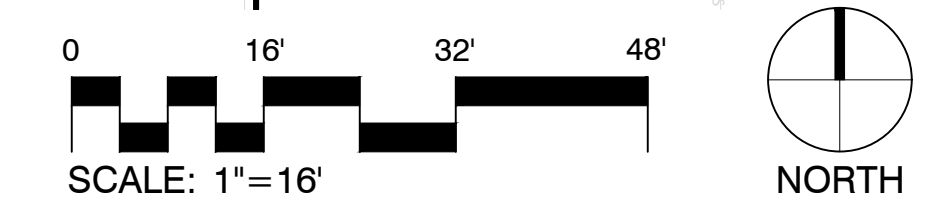

90% SHPO

NORTHFIELD
BRIDGE
SQUARE
NORTHFIELD, MN

I hereby certify that this document was prepared by me or under my direct supervision and that I am a duly licensed Landscape Architect under the laws of the State of Minnesota.

Name Tom Whitlock
Registration# 26292

Signature _____ Date 06/28/2024

DF/ Project # 22-184

Scale AS SHOWN

Drawn/Checked RP/AG/BE/RB

REVISION _____

NOT FOR
CONSTRUCTION

SITE TREE
PLAN

L140

SITE TREE PLAN LEGEND

SYMBOL	CODE	BOTANICAL / COMMON NAME	SIZE
CONIFERS			
	PS	PINUS STROBUS WHITE PINE	18' MIN-22' MAX HT
DECIDUOUS TREES			
	AA	ACER RUBRUM 'ARMSTRONG' ARMSTRONG RED MAPLE	6" CAL.
	GI	GLEDTISIA TRIACANTHOS INERMIS 'SKYCOLE' TM SKYLINE THORNLESS HONEY LOCUST	5" CAL.
	QB	QUERCUS BICOLOR SWAMP WHITE OAK	6" CAL.
	QL	QUERCUS ROBUR X BICOLOR 'LONG' REGAL PRINCE® OAK	6" CAL.
	TG	TILIA CORDATA 'GREENSPIRE' GREENSPIRE LITTLELEAF LINDEN	5" CAL.
		EXISTING TREE TO REMAIN	

NOTES:

- REFER TO L001 FOR GENERAL NOTES AND ABBREVIATIONS.
- REFER TO L002 FOR LANDSCAPE NOTES.
- REFER TO L003 FOR TREE PRESERVATION PLAN, NOTES & DETAILS.
- PROVIDE EROSION CONTROL BLANKET AT SEEDED AREAS 3:1 AND STEEPER. PROVIDE NATIVE STRAW/ HYDROMULCH AT SEEDED AREAS SLOPED LESS THAN 3:1.
- PROVIDE ROADBED DECOMPACTION TO MINIMUM DEPTH OF 12".
- TREE, SHRUB AND PERENNIAL PLANTINGS TO BE PROVIDED AND INSTALLED BY OWNER. SEEDING, RESTORATION, AND SOIL PREP TO BE PROVIDED AND INSTALLED BY CONTRACTOR.
- PLANT MATERIAL, MULCH, SOILS, AND COMPOST SHALL BE INSPECTED FOR JUMPING WORMS PRIOR TO PLACEMENT AND DISTRIBUTION OF MATERIALS ON SITE. INSPECTION SHALL BE PERFORMED BY LANDSCAPE ARCHITECT. NOTIFY LA MINIMUM OF 48 HRS PRIOR TO MATERIAL ARRIVAL. SEE SPECIFICATIONS FOR SUBMITTAL REQUIREMENTS. JUMPING WORMS ARE AN UNCLASSIFIED INVASIVE SPECIES IN MINNESOTA AND PROVIDE A THREAT TO NATURAL ECOSYSTEMS.

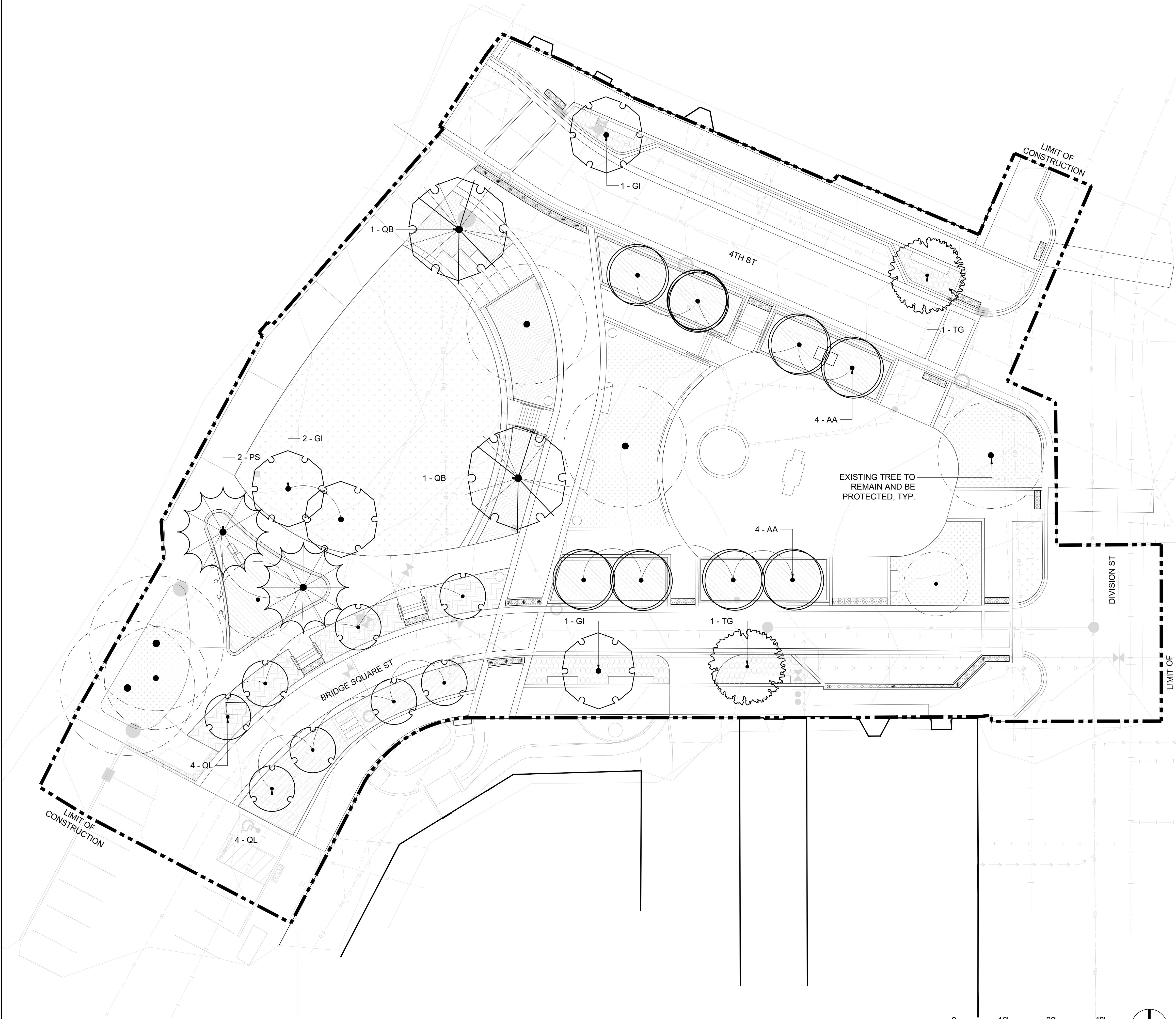

01 SITE TREE PLAN
1" = 16'-0"

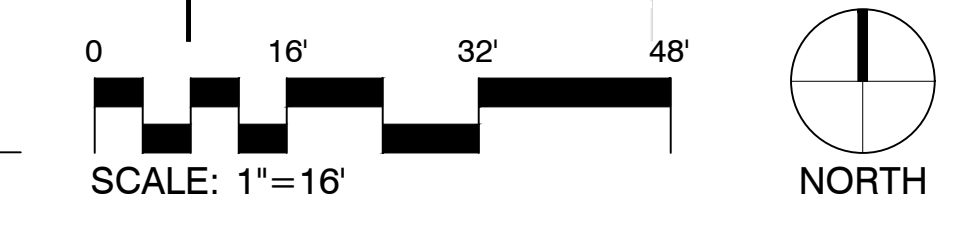

90% SHPO

**NORTHFIELD
BRIDGE
SQUARE**
NORTHFIELD, MN

I hereby certify that this document was prepared by me or under my direct supervision and that I am a duly licensed Landscape Architect under the laws of the State of Minnesota.

Name Tom Whitlock

Registration# 26292

Signature _____ Date _____

06/28/2024

DF/ Project # 22-184

Scale AS SHOWN

Drawn/Checked RPI/AG/BE/RB

REVISION _____

**NOT FOR
CONSTRUCTION**

**SITE
UNDERSTORY
PLANTING**

L141

SITE UNDERSTORY PLANTING LEGEND



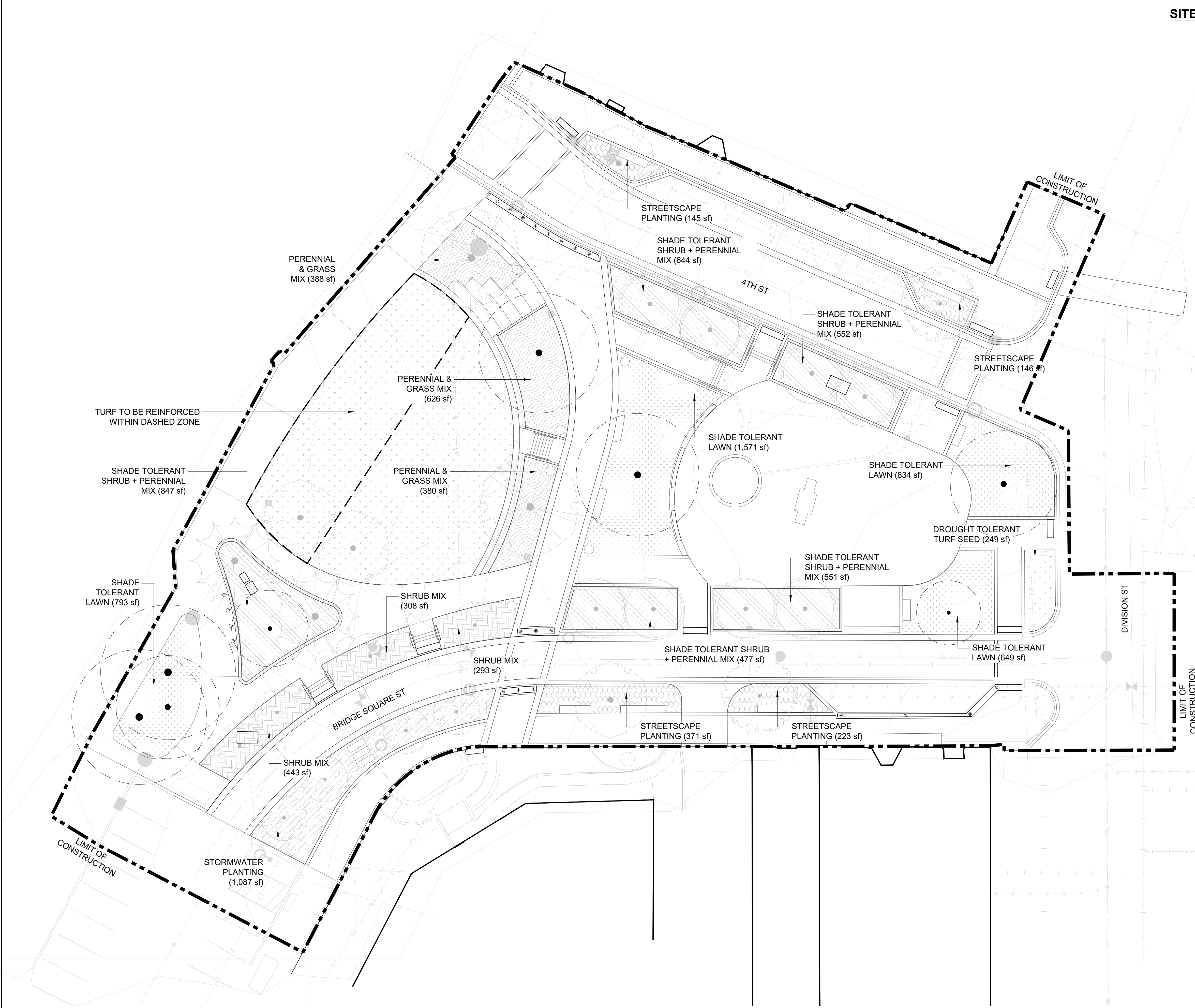



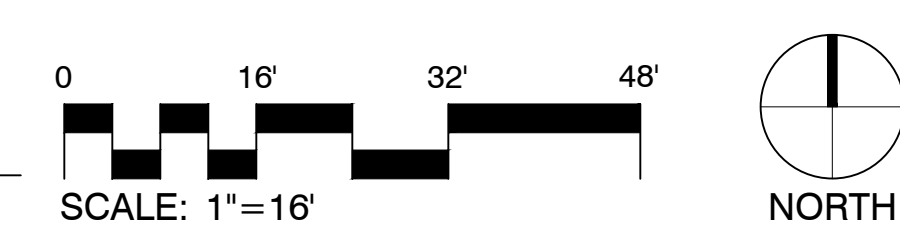

SYMBOL	CODE	BOTANICAL / COMMON NAME
SHRUB, PERENNIAL, AND GRASS MIXES		
[Pattern]		STORMWATER PLANTING
AS2		ALLIUM STELLATUM PRAIRIE ONION
AC		ANEMONE CANADENSIS CANADIAN ANEMONE
AT2		ASCLEPIAS TUBEROSA BUTTERFLY MILKWEED
AP		ASTER PUNICEUS SWAMP ASTER
BA2		BOLTONIA ASTEROIDES FALSE ASTER
CO		CAREX MUSKINGUMENSIS 'OEHME' OEHME PALM SEDGE
CS		CAREX STRICTA TUSsock SEDGE
CV		CAREX VULPINOIDEA FOX SEDGE
PA4		PACKERA AUREA GOLDEN GROUNDSEL
STREETSCAPE PLANTING		
AM		ALLIUM X 'MILLENIUM' MILLENIUM ORNAMENTAL ONION
AB2		ARONIA MELANOCARPA 'UCONNAM166' LOW SCAPE HEDGER® BLACK CHOKEBERRY
CL4		DIERVILLA LONICERA 'MICHIGAN SUNSET' DWARF BUSH HONEYSUCKLE
NW2		NEPETA X 'WALKER'S LOW' WALKER'S LOW CATMINT
RG2		RHUS AROMATICA 'GRO-LOW' GRO-LOW FRAGRANT SUMAC
SA2		SESLERIA AUTUMNALIS AUTUMN MOOR GRASS
SH3		SPOROBOLUS HETEROLEPIS PRAIRIE DROPSEED
PERENNIAL & GRASS MIX		
AM3		ALLIUM X 'MILLENIUM' MILLENIUM ORNAMENTAL ONION
AN		ASTER NOVAE-ANGLIAE NEW ENGLAND ASTER
BA4		BAPTISIA AUSTRALIS BLUE WILD INDIGO
BG		BOUTELOUA GRACILIS BLUE GRAMA GRASS
CP		CAREX PENNSYLVANICA PENNSYLVANIA SEDGE
EC		ECHINACEA PURPUREA PURPLE CONEFLOWER
ET		ECHINACEA X 'TNECHKY' KISMET® YELLOW CONEFLOWER
SH4		SPOROBOLUS HETEROLEPIS PRAIRIE DROPSEED
SHRUB MIX		
CL3		DIERVILLA LONICERA 'MICHIGAN SUNSET' DWARF BUSH HONEYSUCKLE
JX		JUNIPERUS X 'GREY OWL' GREY OWL JUNIPER
RG3		RHUS AROMATICA 'GRO-LOW' GRO-LOW FRAGRANT SUMAC
SHADE TOLERANT SHRUB + PERENNIAL MIX		
AF		AGASTACHE X 'BLUE FORTUNE' BLUE FORTUNE ANISE HYSSOP
AH2		AMSONIA HUBRICHII ARKANSAS BLUESTAR
AC5		ANEMONE CANADENSIS CANADIAN ANEMONE
AD		ARUNCUS DIOICUS GOATSBEARD
BA5		BRUNNERA MACROPHYLLA 'ALEXANDER'S GREAT' ALEXANDER'S GREAT SIBERIAN BUGLOSS
CH		CAREX HOWEI 'WILLOW THE WISP' WILLOW THE WISP HOWE'S SEDGE
GM2		GERANIUM MACULATUM SPOTTED GERANIUM
RG4		RHUS AROMATICA 'GRO-LOW' GRO-LOW FRAGRANT SUMAC
GROUND COVERS		
[Pattern]		DROUGHT TOLERANT TURF SEED
[Pattern]		SHADE TOLERANT LAWN

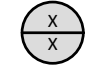

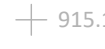
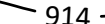
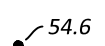
01 SITE UNDERSTORY PLANTING
1" = 16'-0"

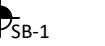

LEGEND

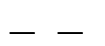
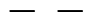
-  REFERENCE KEY TO SITE DETAILS
DETAIL I.D. NUMBER (TOP)
DETAIL SHEET NUMBER (BOTTOM)
-  912 EXISTING CONTOUR
-  915.12 EXISTING SPOT ELEVATION
-  914 PROPOSED CONTOUR
-  54.6 PROPOSED SPOT ELEVATION
ME = MATCH EXISTING
EOF = EMERGENCY OVERTFLOW
TC = TOP OF CURB
TW = FINISH GRADE AT HIGH SIDE OF WALL
BW = FINISH GRADE AT LOW SIDE OF WALL
-  PROPOSED GRADING LIMITS
-  APPROXIMATE SOIL BORING / TEST PIT LOCATION
-  PROPOSED MANHOLE (MH)
-  PROPOSED CATCH BASIN (CB)
-  PROPOSED HYDRANT (HYD)
-  PROPOSED GATE VALVE (GV)
-  PROPERTY LINE

GENERAL NOTES

1. ALL CONSTRUCTION SHALL COMPLY WITH APPLICABLE STATE AND LOCAL ORDINANCES.
2. THE CONTRACTOR WILL BE RESPONSIBLE FOR AND SHALL PAY FOR ALL CONSTRUCTION STAKING / LAYOUT.
3. OBTAIN AND PAY FOR ALL RELATED CONSTRUCTION PERMITS, INCLUDING THE NPDES PERMIT FROM THE MPCA. SUBMIT A COPY OF ALL PERMITS TO THE CITY.
4. CONTRACTOR SHALL BE RESPONSIBLE FOR ALL TRAFFIC CONTROL SIGNAGE (CONSTRUCTION ZONES) NECESSARY TO CONSTRUCT PROPOSED IMPROVEMENTS. ALL SIGNAGE LAYOUTS MUST BE DESIGNED BY THE CONTRACTOR AND APPROVED BY LOCAL AUTHORITIES.
5. INSTALL CONTROL FENCING AND BARRICADING AS NECESSARY TO PROTECT THE PUBLIC.
6. INSPECT SITE AND REVIEW SOIL BORINGS TO DETERMINE EXTENT OF WORK AND NATURE OF MATERIALS TO BE HANDLED.
7. REFER TO SPECIFICATIONS FOR DEWATERING REQUIREMENTS.
8. CHECK ALL PLAN AND DETAIL DIMENSIONS AND VERIFY SAME BEFORE FIELD LAYOUT.
9. REFER TO ARCHITECTURAL PLANS FOR BUILDING AND STOOP DIMENSIONS AND LAYOUT.
10. REFER TO THE STORM WATER POLLUTION PREVENTION PLAN (SWPPP) NARRATIVE, SHEET XXX, FOR EROSION CONTROL REQUIREMENTS. SECTION 31 00 00 SHALL BE RESPONSIBLE FOR FULL IMPLEMENTATION OF THE SWPPP.
11. MAINTAIN ADJACENT PROPERTY AND PUBLIC STREETS CLEAN FROM CONSTRUCTION CAUSED DIRT AND DEBRIS ON A DAILY BASIS. PROTECT DRAINAGE SYSTEMS FROM SEDIMENTATION AS A RESULT OF CONSTRUCTION RELATED DIRT AND DEBRIS.
12. MAINTAIN DUST CONTROL DURING GRADING OPERATIONS.
13. ALL EROSION CONTROL METHODS SHALL COMPLY WITH MPCA AND LOCAL REGULATIONS.
14. MINIMIZE DISTURBANCE TO SITE AND PROTECT EXISTING SITE FEATURES (INCLUDING TURF AND VEGETATION) WHICH ARE TO REMAIN.
15. PROPOSED CONTOURS AND SPOT ELEVATIONS ARE SHOWN TO FINISH GRADE UNLESS OTHERWISE NOTED.
16. PROPOSED ELEVATIONS SHOWN TYPICALLY AS 10.1 OR 10 SHALL BE UNDERSTOOD TO MEAN 910.1 OR 910.
17. SPOT ELEVATIONS SHOWN IN PARKING LOTS, DRIVES AND ROADS INDICATE GUTTER GRADES, UNLESS NOTED OTHERWISE. SPOT ELEVATIONS WITH LABELS OUTSIDE THE BUILDING PERIMETER INDICATE PROPOSED GRADES OUTSIDE THE BUILDING. SPOT ELEVATIONS WITH LABELS INSIDE THE BUILDING PERIMETER INDICATE PROPOSED FINISH FLOOR ELEVATIONS.
18. THE CONTRACTOR WILL BE SOLELY RESPONSIBLE FOR DETERMINING QUANTITIES OF CUT, FILL AND WASTE MATERIALS TO BE HANDLED, AND FOR AMOUNT OF GRADING TO BE DONE IN ORDER TO COMPLETELY PERFORM ALL WORK INDICATED ON THE DRAWINGS. IMPORT SUITABLE MATERIAL AND EXPORT UNSUITABLE / EXCESS / WASTE MATERIAL, AS REQUIRED, AT NO ADDITIONAL COST TO THE OWNER.
19. NO FINISHED SLOPES SHALL EXCEED 4' HORIZONTAL TO 1' VERTICAL (4:1), UNLESS OTHERWISE NOTED.
20. ALL DISTURBED AREAS OUTSIDE WHICH ARE NOT DESIGNATED TO BE PAVED SHALL RECEIVE AT LEAST 6" OF TOPSOIL AND SHALL BE SODDED OR SEEDED.
21. WHERE NEW SOD MEETS EXISTING SOD, CUT A CLEAN, SHARP EDGE TO ALLOW FOR A CONSISTENT, UNIFORM, AND STRAIGHT JOINT BETWEEN NEW SOD AND EXISTING TURFGRASS. JAGGED OR UNEVEN JOINTS WILL NOT BE ACCEPTED. REMOVE TOPSOIL AT THE JOINT BETWEEN NEW SOD AND EXISTING TURFGRASS, AS REQUIRED, TO ALLOW NEW SOD SURFACE TO BE FLUSH WITH EXISTING TURFGRASS SURFACE.
22. FAILURE OF TURF DEVELOPMENT: IN THE EVENT THE CONTRACTOR FAILS TO PROVIDE AN ACCEPTABLE TURF, RE-SEED OR RE-SOD ALL APPLICABLE AREAS, AT NO ADDITIONAL COST TO THE OWNER, TO THE SATISFACTION OF THE ENGINEER OR LANDSCAPE ARCHITECT.
23. ALL WATERMAIN SHALL BE AWWA C900, CAST IRON OD, DR 18, PVC PIPE INSTALLED IN ACCORDANCE WITH ASTM D2321. ALL WATERMAIN SHALL HAVE MINIMUM 8'-0" BURY (TOP OF PIPE TO FINISH GRADE).

BENCHMARKS (FIELD VERIFY BEFORE USING)

1. TOP NUT OF HYDRANT LOCATED EAST OF DIVISION ST & SOUTH OF E 4TH ST.
ELEV: 919.22
2. TOP NUT OF HYDRANT LOCATED AT THE SW CORNER OF WATER ST S AND E 4TH ST.
ELEV: 913.49
3. TOP NUT OF HYDRANT LOCATED WEST OF WATER ST S AND NW OF THE UNITED STATES POSTAL SERVICE BUILDING 75' (+/-)
ELEV: 911.99

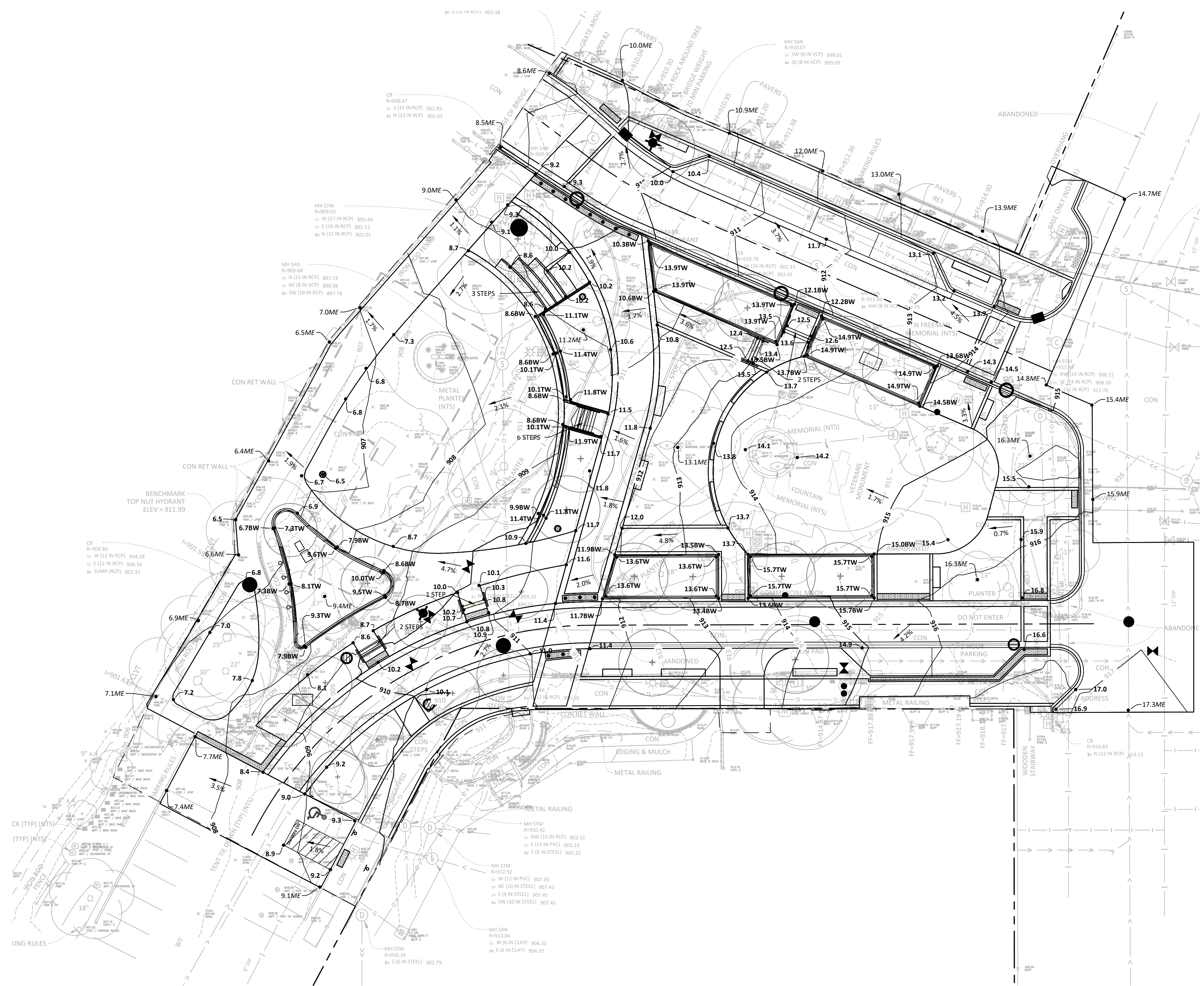

90% SHPO

**NORTHFIELD
BRIDGE
SQUARE**
NORTHFIELD, MN

I hereby certify that this document was prepared by me or under my direct supervision and that I am a duly licensed Landscape Architect under the laws of the State of Minnesota.

Name Tom Whitlock
Registration# 26292

Signature _____ Date 06/17/2024

DF/ Project # 22-184

Scale AS SHOWN

Drawn/Checked RP/AG/BE/RB

REVISION _____

NOT FOR CONSTRUCTION

**GRADING AND
DRAINAGE
PLAN**

C3.01

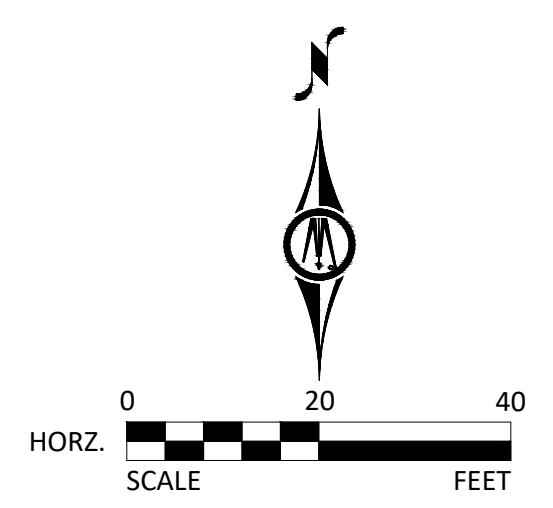

THIS DRAWING INDICATES LIGHTING EQUIPMENT LAYOUT AND DESIGN OF LIGHTING SYSTEMS. REVIEW BY A QUALIFIED ENGINEER IS NECESSARY TO ASSURE SAFETY AND CODE COMPLIANCE.

FOR REFERENCE ONLY
REFER TO E-SERIES DRAWINGS FOR ELECTRICAL FEEDS, DISCONNECT SWITCHES, CONDUIT, AND WIRE FOR ALL LIGHTING EQUIPMENT. DIVISION 26 CONTRACTOR SHALL PROVIDE AND INSTALL ALL LIGHTING EQUIPMENT AND CONTROL WIRING FOR A COMPLETE AND OPERABLE SYSTEM.

PRELIMINARY
NOT FOR CONSTRUCTION

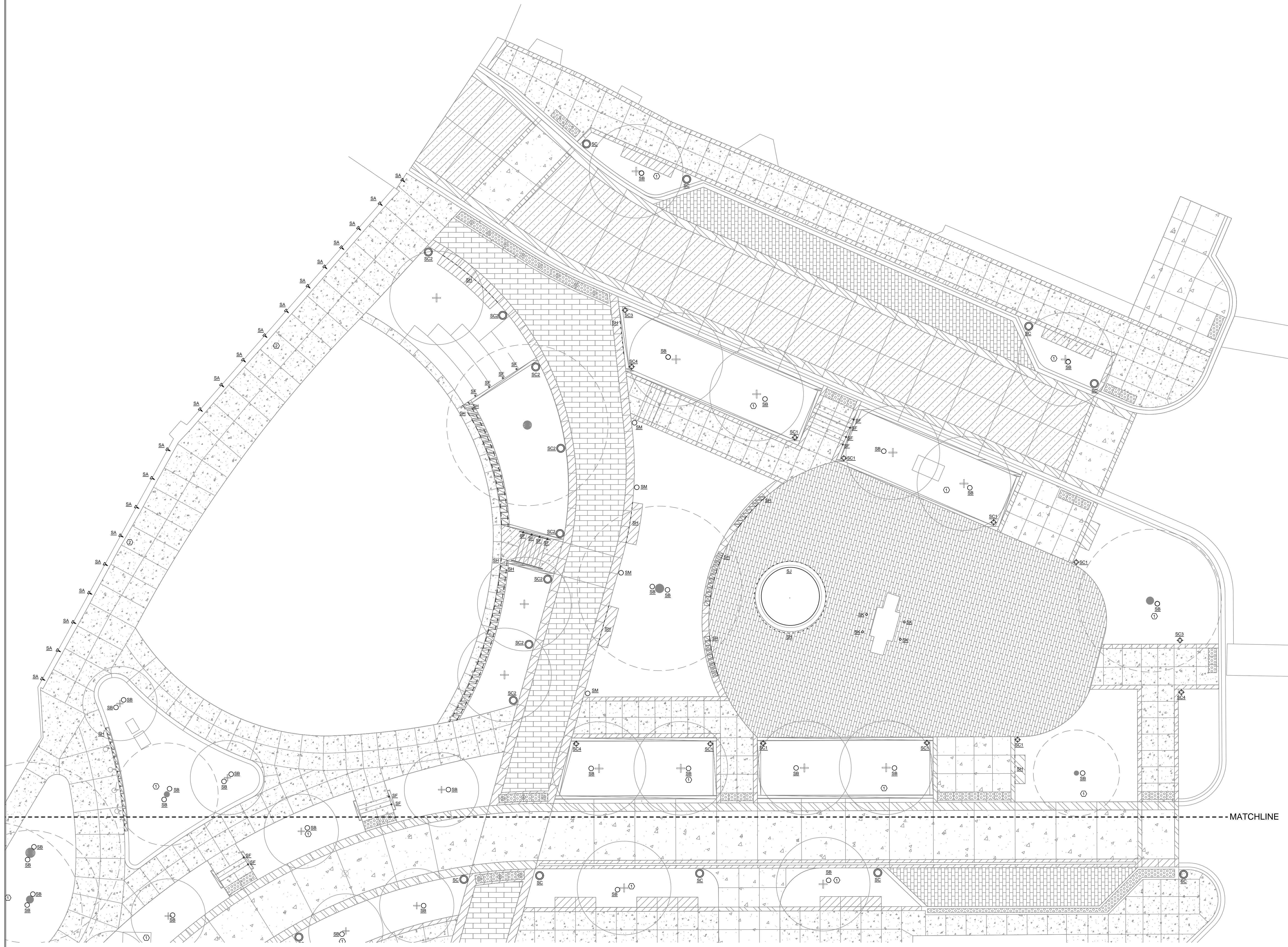

90% SHPO

**NORTHFIELD
BRIDGE
SQUARE**
NORTHFIELD, MN

06/14/2024

DF/ Project #	22-184
Scale	AS SHOWN
Drawn/Checked	ATP/PPW

REVISION

**NOT FOR
CONSTRUCTION**

GENERAL NOTES:
A. INSTALLATION SHALL CONFORM TO ALL APPLICABLE NEC, ILL. STATE AND LOCAL CODES.
B. ALL EMERGENCY EGRESS LIGHTING IS THE RESPONSIBILITY OF THE ELECTRICAL ENGINEER OR ELECTRICAL CONTRACTOR.
C. ALL DIMMING CIRCUITS ARE TWO WIRE. NO COMMON NEUTRALS SHALL BE USED.
D. FIELD PAINT ALL CONDUIT, JUNCTION BOXES AND HARDWARE TO MATCH ADJACENT SURFACES.
E. ELECTRICAL CONTRACTOR SHALL VERIFY ALL MOUNTING CONDITIONS, AND MOUNTING HARDWARE REQUIRED PRIOR TO PURCHASE OF ANY LIGHTING FIXTURES.
F. ELECTRICAL CONTRACTOR SHALL VERIFY MOUNTING HEIGHTS OF ALL FIXTURES WITH SCHULER SHOOK PRIOR TO INSTALLATION.

KEYED NOTES:
1. PROVIDE DUPLEX IN PLANTER FOR SEASONAL LIGHTING.
2. INTEGRATE FIXTURE INTO HANDRAIL. REFER TO LANDSCAPE DRAWINGS.

MATCHLINE



THIS DRAWING INDICATES LIGHTING EQUIPMENT LAYOUT AND DESIGN OF LIGHTING SYSTEMS. REVIEW BY A QUALIFIED ENGINEER IS NECESSARY TO ASSURE SAFETY AND CODE COMPLIANCE.

FOR REFERENCE ONLY
REFER TO E-SERIES DRAWINGS FOR ELECTRICAL FEEDS, DISCONNECT SWITCHES, CONDUIT, AND WIRE FOR ALL LIGHTING EQUIPMENT. DIVISION 26 CONTRACTOR SHALL PROVIDE AND INSTALL ALL LIGHTING EQUIPMENT AND CONTROL WIRING FOR A COMPLETE AND OPERABLE SYSTEM.

PRELIMINARY
NOT FOR CONSTRUCTION



CITY OF NORTHFIELD
801 WASHINGTON STREET
NORTHFIELD, MINNESOTA 55057
DAVID.BENNETT@CI.NORTHFIELD.MN.US

DAMON FARBER LANDSCAPE ARCHITECTS
310 S 4TH AVE
MINNEAPOLIS, MN 55415
RBLASEG@DAMONFARBER.COM
612.332.7522

BOLTON & MENK
7575 GOLDEN VALLEY ROAD
SUITE 200
MINNEAPOLIS, MN 55427
DAVE.REY@BOLTON-MENK.COM
763.544.7129

NELSON-RUDIE & ASSOCIATES,
9100 49TH AVE N,
MINNEAPOLIS, MN 55428
SARAH.GREFF@NELSONRUDIE.COM
763.367.7600

SCHULER & SHOOK
219 SE MAIN ST
MINNEAPOLIS, MN 55414
PWHITAKER@SCHULERSHOOK.COM
612.339.5958

90% SHPO

NORTHFIELD BRIDGE SQUARE
NORTHFIELD, MN

1 SITE LIGHTING - LIGHTING LAYOUT
AL101 SCALE: 3/32" = 1'-0"

TYPE	REV	FIXTURE DESCRIPTION	CATALOG NUMBER	VOLTS	WATTS	CONTROL TYPE	DIMMING RANGE	DRIVER REMARKS	SOURCE	DELIVERED LUMENS	CCT	CRI	DISTRIBUTION	FIXTURE REMARKS
SA		STEP LIGHT	BEGA 24204 X3 BLX	24	2.1	NON-DIM			LED	3000	>90			STEP LIGHT
SB		TREE MOUNTED FLOODLIGHT	(2) BK LIGHTING DE-LED-168-F-LBLP-12-11-45 / BK TS-TMC-BLP-19 / RM-D27NC-BLP-MT. LOCATION OF REMOTE RIVER IN GROUND MOUNTED BOX TBD.	240	27	NON-DIM			LED	1597	3000	>90		TREE MOONLIGHT
SC		SCULPTURE	SCULPTURE WITH INTEGRAL LIGHTING PROVIDED BY OTHERS	240	92	NON-DIM			LED	8200	2700	>80		STREET POLES
SC1		POLE WITH MULTIPLE HEADS	SELUX OLPL-F40-SB8-2G350-30-BK-240-DS-0G-0S-0M-16-18-0-AT335-156-16-BK-RN6-BC3-REC2	240	70	NON-DIM			LED	6730	3000	>80		PLAZA POLES
SC2		DECORATIVE POLE	DECORATIVE POLE TBD.											COLONADE POLE
SC3		POLE WITH MULTIPLE HEADS	SELUX OLPL-F40-SB2-2G350-30-BK-240-DS-0G-0S-0A-1205-156-16-BK-RN6-BC3-REC2	240	28	NON-DIM			LED	6730	3000	>80		PLAZA POLES
SC4		POLE WITH MULTIPLE HEADS	SELUX OLPL-F40-SB3-2G350-30-BK-240-DS-0G-0S-0M-0-AT335-156-16-BK-RN6-BC3-REC2	240	42	NON-DIM			LED	6730	3000	>80		PLAZA POLES
SD		COLUMN DOWNLIGHT	BK LIGHTING AR-LED-RM-43-SP-WHP-9-11-90-3"-WM/RM-NC-WHP-MT. Contractor is responsible for remote power supply, tests, and fittings as required for a complete and operable system.	240	10	NON-DIM			LED	1230	3000	>80		PERGOLA COLUMN DOWNLIGHT
SE		NOT USED												
SF		INTEGRAL HANDRAIL	ALPHABET-750S 27K VA P88 CF. PROVIDE P70414 500 ECO DRIVERS AS REQUIRED.	240	2.2W	NON-DIM			LED	180	3000			INTEGRAL HANDRAIL LIGHT
SG		NOT USED												
SH		LINEAR SURFACE MOUNT LED	LUMINI KBX-SF-H-30K-EFP-EFP-X-XX" MOUNT POWER SUPPLY UNDER BENCH. POWER SUPPLY LOCATION TBD AT FOUNTAIN.	240	5W/FT	NON-DIM			LED	335 LM/FT	3000			BENCH AND OUTER FOUNTAIN LED
SI		NOT USED												
SJ		SUBMERSIBLE LINEAR	LUMINI KBX-SF-V-PL-30K-SBFF-SBFF-X-XX" MOUNT POWER SUPPLY UNDER BENCH. POWER SUPPLY LOCATION TBD	240	3.7W/FT	NON-DIM			LED	178	3000			FOUNTAIN SUBMERSIBLE LINEAR
SK		INGRADE UPLIGHT	BK LIGHTING HP2-LED-TR-X44-FL-XXX-10-11-TC-	240	34	NON-DIM			LED	2814	3000	>80		MONUMENT UPLIGHT
SM		BOLLARD	BEGA 84220 X3 BLX	240	15	NON-DIM			LED	1475	3000	>80		BOLLARD

GENERAL NOTES:

- CONTRACTOR SHALL VERIFY ALL MOUNTING AND RECESS CONDITIONS PRIOR TO ORDERING FIXTURES
- CONTRACTOR SHALL PROVIDE ALL HARDWARE, BRACKETS, WIRING, TRANSFORMERS, REMOTE BOXES AND EQUIPMENT TO INSTALL A COMPLETE AND FUNCTIONAL SYSTEM
- NO SUBSTITUTIONS SHALL BE ACCEPTED WITHOUT PRIOR REVIEW AND WRITTEN APPROVAL BY SCHULER SHOOK
- LIGHT FIXTURE MANUFACTURERS AND ELECTRICAL CONTRACTORS TO VERIFY COMPATIBILITY OF ALL DIMMING TRANSFORMERS, DRIVERS AND BALLASTS WITH THE LIGHTING CONTROL SYSTEM.
- PRICES SHOWN ARE DISTRIBUTOR NET PRICING AND DO NOT INCLUDE TAXES, FREIGHT, MARK-UP (DISTRIBUTOR OR CONTRACTOR) OR INSTALLATION COST. PRICES ARE PER FIXTURE OR LINEAR FOOT.
- PRIOR TO ORDERING LUMINAIRES, CONTRACTORS SHALL VERIFY THE COMPATIBILITY OF ALL LED DRIVERS WITH THE CONTROLS BEING ORDERED. WHERE DIMMING IS REQUIRED, CONTROL DEVICES SHALL BE COMPATIBLE TO ACCESS THE FULL DIMMING CAPABILITY OF THE SPECIFIED LED FIXTURE AND DRIVER COMBINATION (WITH NO VISIBLE FLICKER OR STEPPING CLAMPY STEPPING). FAILURE TO COORDINATE DIMMERS AND DRIVERS THAT RESULT IN POOR DIMMING PERFORMANCE, AS DETERMINED BY THE LIGHTING DESIGNER AND/OR OWNER OR ELECTRICAL ENGINEER, SHALL BE RECTIFIED BY THE CONTRACTOR AT NO COST TO THE OWNER.
- CONTRACTOR WILL FAMILIARIZE THEMSELVES WITH ADDRESSING OF LED FIXTURES AT BEGINNING OF PROJECT. PRIOR TO INSTALLATION. CONTRACTOR SHALL PROVIDE A SYSTEMS INTEGRATOR FOR ALL DIMMING SYSTEM.

GENERAL NOTES:

- INSTALLATION SHALL CONFORM TO ALL APPLICABLE NEC, UL, STATE AND LOCAL CODES.
- ALL EMERGENCY EGRESS LIGHTING IS THE RESPONSIBILITY OF THE ELECTRICAL ENGINEER OR ELECTRICAL CONTRACTOR.
- ALL DIMMING CIRCUITS ARE TWO-WIRE. NO COMMON NEUTRALS SHALL BE USED.
- FIELD PAINT ALL CONDUIT, JUNCTION BOXES AND HARDWARE TO MATCH ADJACENT SURFACES.
- ELECTRICAL CONTRACTOR SHALL VERIFY ALL MOUNTING CONDITIONS AND MOUNTING HARDWARE REQUIRED PRIOR TO PURCHASE OF ANY LIGHTING FIXTURES.
- ELECTRICAL CONTRACTOR SHALL VERIFY MOUNTING HEIGHTS OF ALL FIXTURES WITH SCHULER SHOOK PRIOR TO INSTALLATION.

KEYED NOTES:

- PROVIDE DUPLEX IN PLANTER FOR SEASONAL LIGHTING.
- INTEGRATE FIXTURE INTO HANDRAIL. REFER TO LANDSCAPE DRAWINGS.

2 SITE LIGHTING - LIGHT FIXTURE SCHEDULE
AL101 SCALE: NO SCALE

06/14/2024
DF/Project # 22-184
Scale AS SHOWN
Drawn/Checked ATP/PPW
REVISION
NOT FOR CONSTRUCTION

AL101

THIS DRAWING INDICATES LIGHTING EQUIPMENT LAYOUT AND DESIGN OF LIGHTING SYSTEMS. REVIEW BY A QUALIFIED ENGINEER IS NECESSARY TO ASSURE SAFETY AND CODE COMPLIANCE.

FOR REFERENCE ONLY
 REFER TO E-SERIES DRAWINGS FOR ELECTRICAL FEEDS, DISCONNECT SWITCHES, CONDUIT, AND WIRE FOR ALL LIGHTING EQUIPMENT. DIVISION 26 CONTRACTOR SHALL PROVIDE AND INSTALL ALL LIGHTING EQUIPMENT AND CONTROL WIRING FOR A COMPLETE AND OPERABLE SYSTEM.

PRELIMINARY
 NOT FOR CONSTRUCTION

90% SHPO

NORTHFIELD BRIDGE SQUARE
 NORTHFIELD, MN

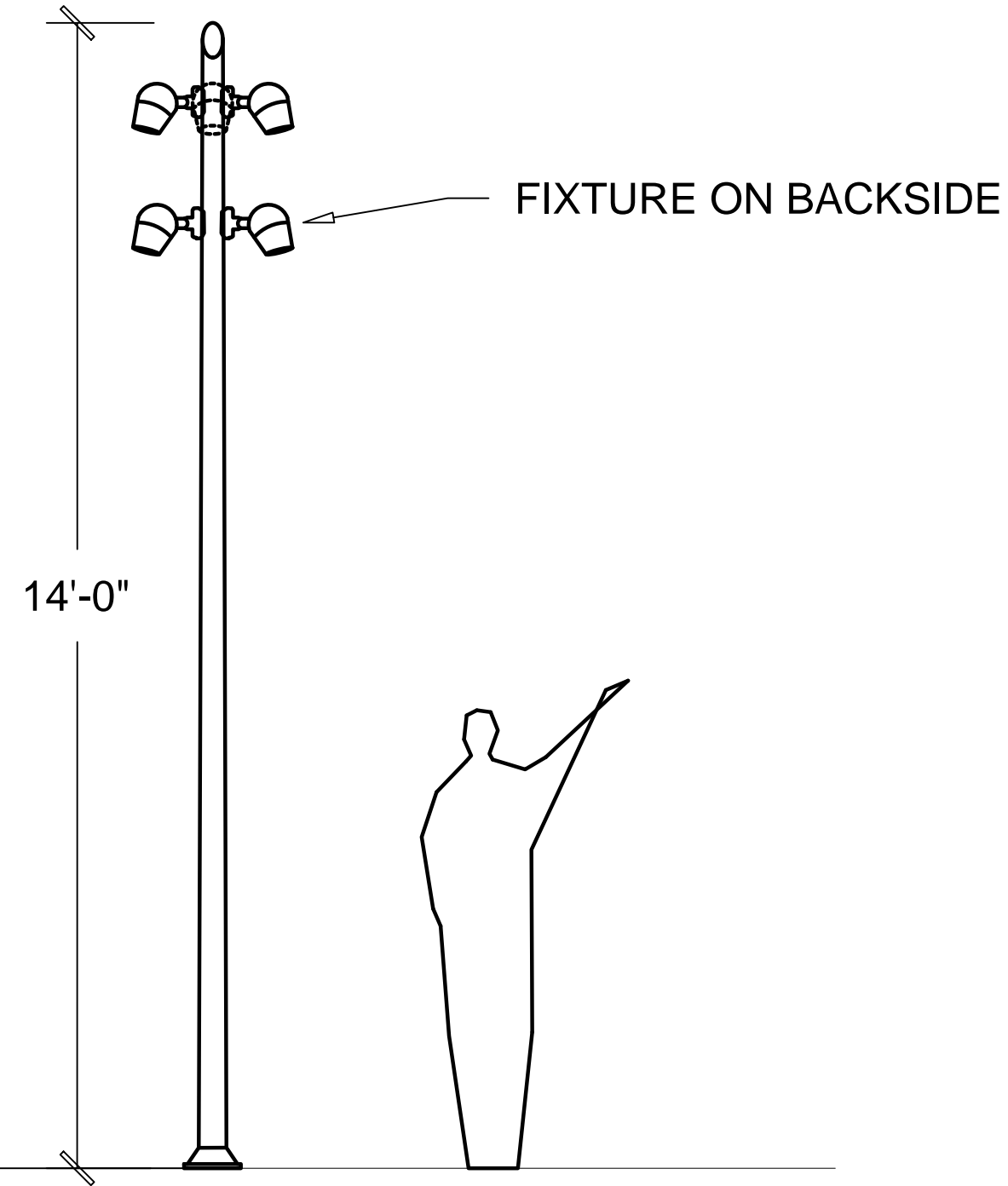

1 SITE LIGHTING - TYPE SC1 FIXTURE ELEVATION
 AL102 SCALE: NO SCALE

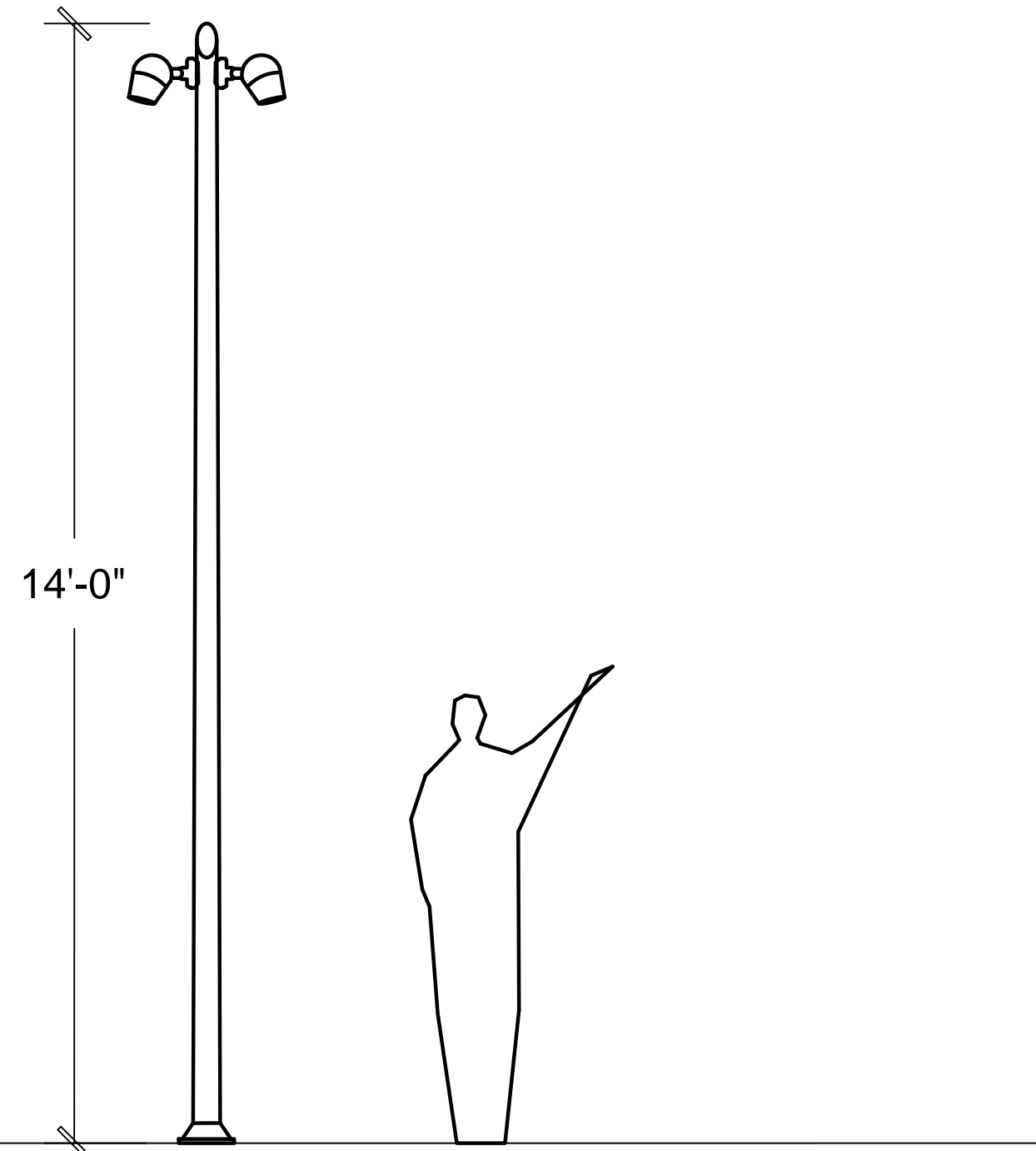

2 SITE LIGHTING - TYPE SC3 FIXTURE ELEVATION
 AL102 SCALE: NO SCALE

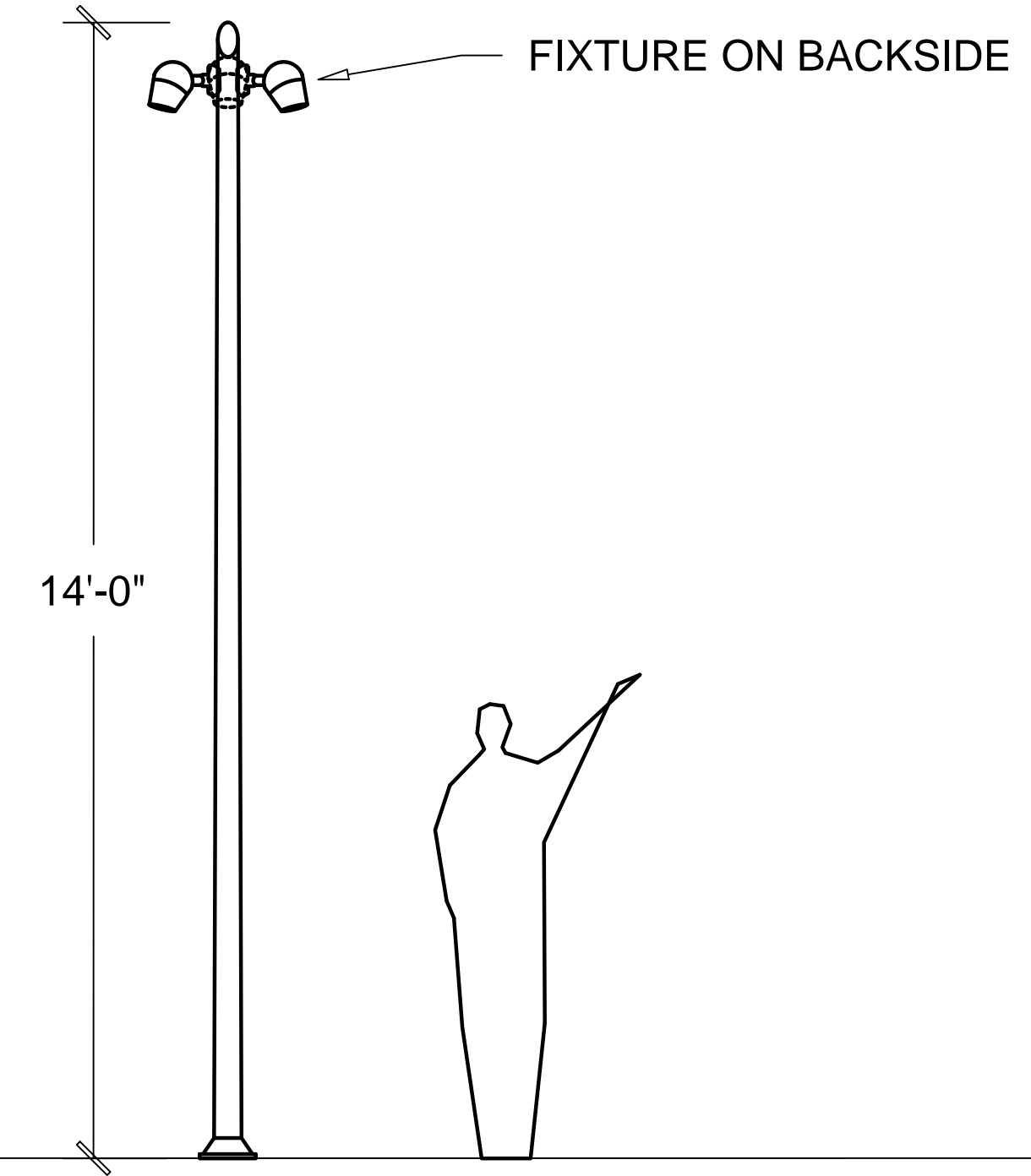

3 SITE LIGHTING - TYPE SC4 FIXTURE ELEVATION
 AL102 SCALE: NO SCALE

GENERAL NOTES:
 A. INSTALLATION SHALL CONFORM TO ALL APPLICABLE NEC, UL, STATE AND LOCAL CODES.
 B. ALL EMERGENCY EGRESS LIGHTING IS THE RESPONSIBILITY OF THE ELECTRICAL ENGINEER OR ELECTRICAL CONTRACTOR.
 C. ALL DIMMING CIRCUITS ARE TWO-WIRE. NO COMMON NEUTRALS SHALL BE USED.
 D. FIELD PAINT ALL CONDUIT, JUNCTION BOXES AND HARDWARE TO MATCH ADJACENT SURFACES.
 E. ELECTRICAL CONTRACTOR SHALL VERIFY ALL MOUNTING CONDITIONS AND MOUNTING HARDWARE REQUIRED PRIOR TO PURCHASE OF ANY LIGHTING FIXTURES.
 F. ELECTRICAL CONTRACTOR SHALL VERIFY MOUNTING HEIGHTS OF ALL FIXTURES WITH SCHULER SHOOK PRIOR TO INSTALLATION.

KEYED NOTES:
 1. PROVIDE DUPLEX IN PLANTER FOR SEASONAL LIGHTING.
 2. INTEGRATE FIXTURE INTO HANDRAIL. REFER TO LANDSCAPE DRAWINGS.

NOT FOR CONSTRUCTION

DF/ Project #	22-184
Scale	AS SHOWN
Drawn/Checked	ATP/PPW

REVISION	DATE