

CITY OF NORTHFIELD, MN
CITY COUNCIL RESOLUTION 2018-077
APPROVAL OF THE PRELIMINARY PLAT OF THE BLUFF VIEW ADDITION

WHEREAS, Vernon and Joan Koester, ("Applicants") have submitted an application for Preliminary Plat approval for the Bluff View Addition, legally described as Outlot B Southbridge Second Addition, Northfield, Rice County, Minnesota; and

WHEREAS, City Staff have reviewed the submittal of the Preliminary Plat and have determined that it meets the requirements of the Land Development Code; and

WHEREAS, the Planning Commission considered the Applicant's request for a Preliminary Plat at a duly noticed Public Hearing, which took place on April 19, 2018, and recommended approval to the City Council.

NOW, THEREFORE, BE IT RESOLVED BY THE CITY COUNCIL THAT:

The Preliminary Plat of the Bluff View Addition is hereby approved, subject to the following conditions:

1. All Final Plats shall comply with the provisions of all state statutes and standard procedures for platting in Rice County.
2. Prior to the City's execution of a Final Plat, the Applicant must enter into an agreement with the City for the installation of all required improvements, which shall be referred to as the "Development Agreement."

PASSED by the City Council of the City of Northfield on this 21st day of August, 2018.

ATTEST



City Clerk



Mayor

VOTE: Y POWNELL Y COLBY Y DELONG A NAKASIAN
 Y NESS Y PETERSON WHITE A ZWEIFEL

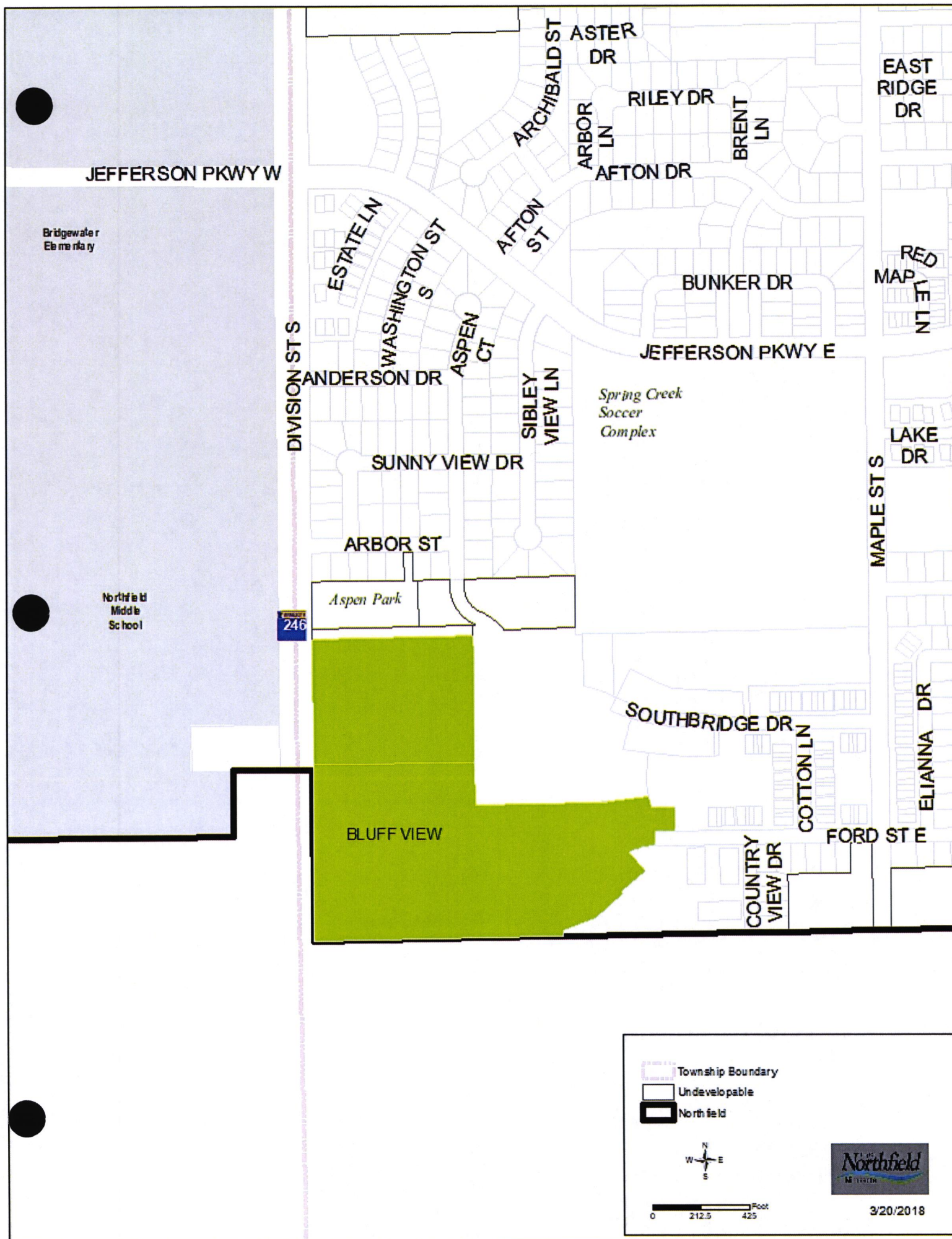

BLUFF VIEW

OUTLOT A ADDITION

N00°14'25"W 190.02

N89°29'26"E 511.77

R=730.00
Δ=6°04'09"
L=77.33

N83°29'51"W
108.95

N09°57'37"W
46.76

S89°29'26"W
101.80

N00°30'34"W
107.33

N89°29'26"E
88.84

OUTLOT B

OUTLOT C

N00°30'34"W
60.00

N89°29'26"E
88.84

N00°30'34"W
107.33

N89°29'26"E
88.84

OUTLOT B

BLOCK 1
2
2

BLOCK 1
2
3

BLOCK 3
3
4
5
6
7
8
9
10
11

BLOCK 3
12
13
14
15

BLOCK 4
2
3
4
5

FORD STREET

ASPEN STREET

FORD STREET

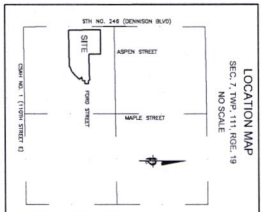

1077.51