

**WARNING:**

THE CONTRACTOR SHALL BE RESPONSIBLE FOR CALLING FOR LOCATIONS OF ALL EXISTING UTILITIES. THEY SHALL COOPERATE WITH ALL UTILITY COMPANIES IN MAINTAINING THEIR SERVICE AND/OR RELOCATION OF LINES.

THE CONTRACTOR SHALL CONTACT GOPHER STATE ONE CALL AT 651-454-0002 AT LEAST 48 HOURS IN ADVANCE FOR THE LOCATIONS OF ALL UNDERGROUND WIRES, CABLES, CONDUITS, PIPES, MANHOLES, VALVES OR OTHER BURIED

STRUCTURES BEFORE DIGGING. THE CONTRACTOR SHALL REPAIR OR REPLACE THE ABOVE WHEN DAMAGED DURING CONSTRUCTION AT NO COST TO THE OWNER.

CALL BEFORE YOU DIG  
**GOPHER STATE ONE CALL**

TWIN CITY AREA: 651-454-0002  
 TOLL FREE 1-800-252-1166

NOTES: SEE SHEET C-100

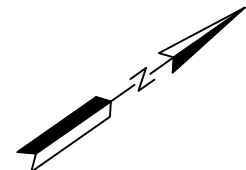
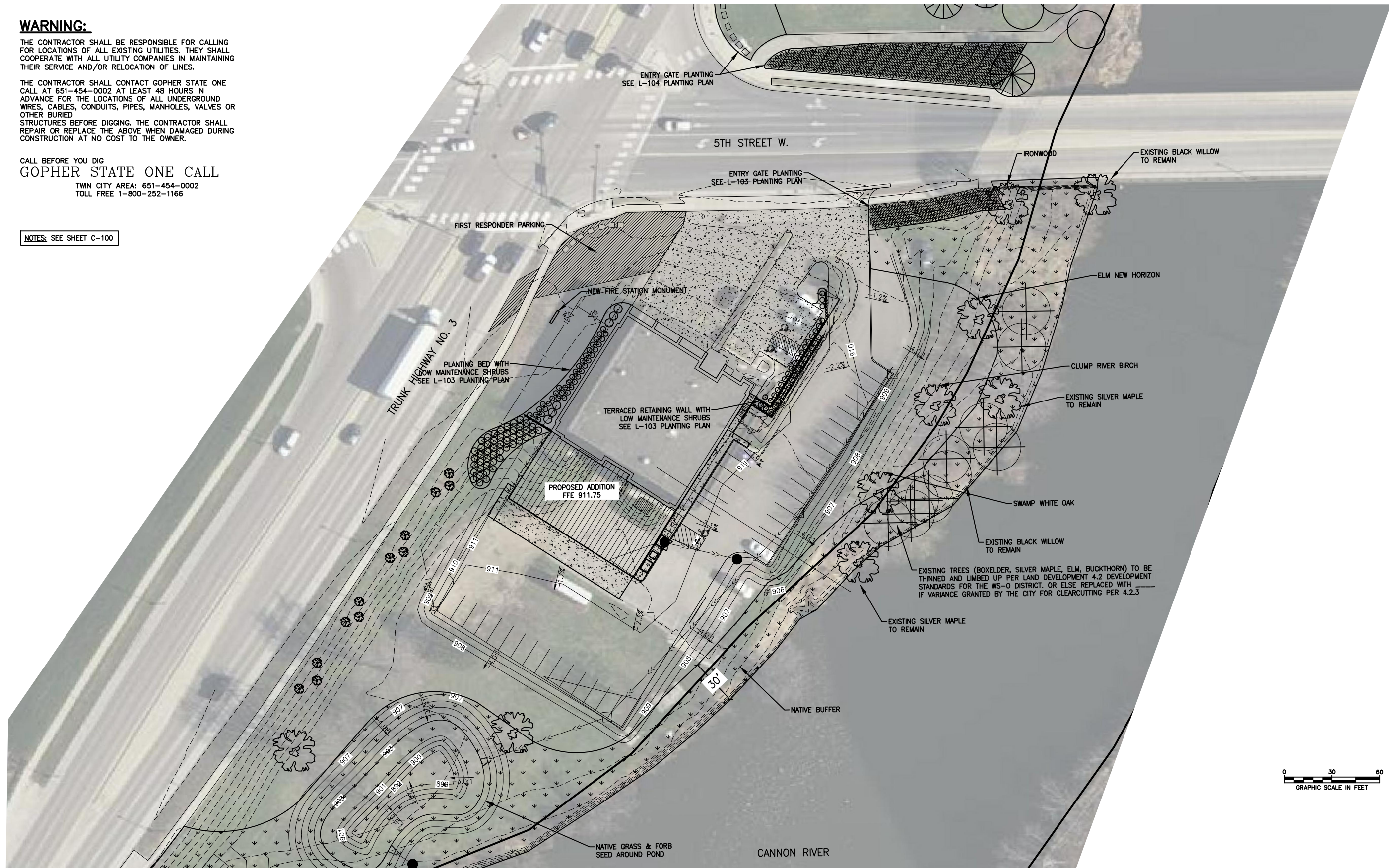

#	DESCRIPTION	XXX	XXX	XX/XX/XX
REV	REVISION DESCRIPTION	DWN	APP	REV DATE

SEAL

NOT FOR  
CONSTRUCTION

CONSULTANT



Responsive partner. Exceptional outcomes.

PROJECT TITLE  
**NORTHFIELD FIRE STATION ADDITION**

CITY OF NORTHFIELD

SHEET TITLE LANDSCAPE PLAN OVERVIEW			
DWN BY MJS	CHK'D	APP'D	DWG DATE APRIL 2017
PROJECT NO.	SHEET NO.	SCALE AS SHOWN	
		L-102	
		REV NO.	